

# Vermeer®



Chains

Cutting Teeth

Sprockets

Bearings

Carbide Teeth

## **BALLANTINE**

*Building The World's Infrastructure*



Anoka, Minnesota

Atlanta, Georgia

Ontario, California

Centralized Customer Service: 800/328-2424

[www.ballantineinc.com](http://www.ballantineinc.com)

# **Faster Service Better Quality Lower Prices**

## **Replacement Parts for Vermeer®**

Effective 6/09

Replacement Parts for Vermeer® Trenchers

Vermeer® is a registered trademark of Vermeer Manufacturing, Pella, IA

### Ordering Instructions

All credit accounts must be approved by our Anoka, Minnesota office.  
Please order by part number and give the make and model of your machine.

The enclosed parts and price list supersedes all others.  
(Prices are subject to change without notice.)

#### **Main Office**

840 McKinley Street  
Anoka, Minnesota 55303

#### **Branch Office**

675 Wesleyan Drive Southwest  
Atlanta, Georgia 30336

#### **Branch Office**

801 South Dupont, Suite G  
Ontario California 91761

#### **Toll Free Customer Service**

Toll Free **800-328-2424**  
FAX **763-427-2277**

**Make of Machine:** \_\_\_\_\_

**Model:** \_\_\_\_\_

Measure Pitch Size (Center of Pin to Center of Next Pin)

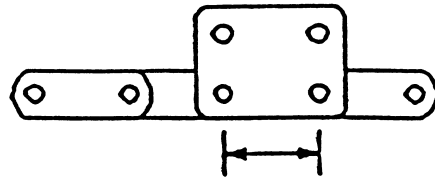

- |                          |                          |                          |                          |                          |                          |                          |                          |                          |                          |                          |                          |
|--------------------------|--------------------------|--------------------------|--------------------------|--------------------------|--------------------------|--------------------------|--------------------------|--------------------------|--------------------------|--------------------------|--------------------------|
| 1.654"                   | 2.000"                   | 2.043"                   | 2.609"                   | 2.648"                   | 3.067"                   | 3.075"                   | 3.110"                   | 3.125"                   | 3.250"                   | 4.000"                   | 4.500"                   |
| <input type="checkbox"/> | <input type="checkbox"/> | <input type="checkbox"/> | <input type="checkbox"/> | <input type="checkbox"/> | <input type="checkbox"/> | <input type="checkbox"/> | <input type="checkbox"/> | <input type="checkbox"/> | <input type="checkbox"/> | <input type="checkbox"/> | <input type="checkbox"/> |

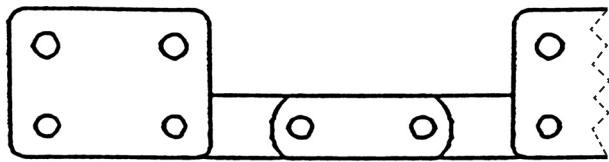

Every 4th Pitch Attachment Spacing

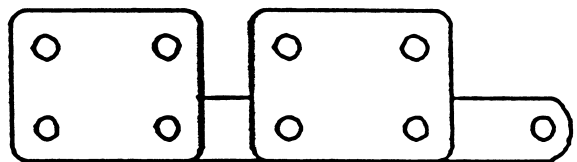

Every 2nd Pitch Attachment Spacing

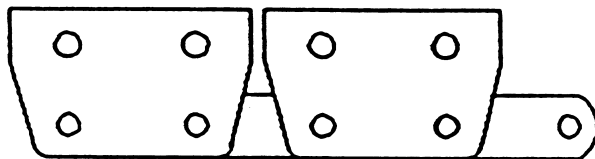

Anti-Backflex Chain

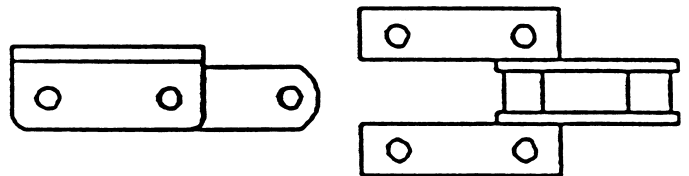

K-Style Chain

**Determining the number of pitches in a chain.**

One pitch equals the distance from one pin to the next pin. The example below is 20 pitches long.

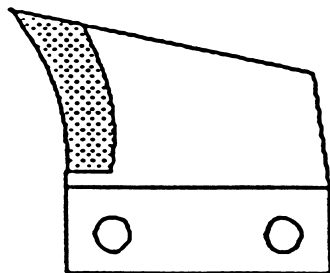
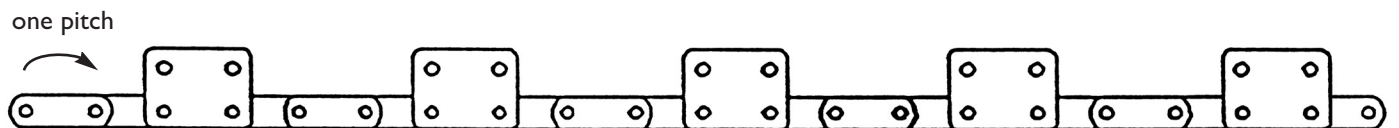

Left-hand cutter

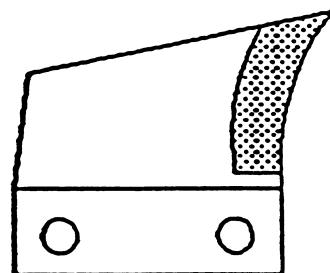

Right-hand Cutter

\* Auburn Cutters are the Opposite

# Chain Assembly Guide

CHAIN ASSEMBLY STYLES	GROUND CONDITIONS/APPLICATION					
	Heavy/Wet	Sandy	Loose Dirt	Medium	Hard	Rocky
Cup Assembly/4 pitch	■	■	■	▨	□	□
Cup Assembly/2 pitch	▨	■	■	▨	▨	□
Combo/Terminator-Cup	□	□	▨	■	■	▨
Combo/Rock & Frost-Cup	□	□	▨	■	■	▨
Full Terminator (bolt-on)	□	□	□	▨	■	▨
Full Rock & Frost (bolt-on)	□	□	□	▨	■	■
LP Welded Terminator	□	□	▨	■	■	▨
LP Welded Alligator	□	□	□	▨	■	■
LP Welded H-Plate	□	□	□	▨	■	■
Anti Back-Flex Chains	Recommended as an upgrade to any of the chain assemblies listed. ABF Chains are designed for more severe ground conditions.					

This chart shows the most popular styles of chain assemblies and recommended guidelines as to their usage. Only basic categories of ground conditions are shown.

These are recommendations only. Please consult a Ballantine representative when matching chain assemblies with specific ground conditions or any special application requirements.

**Key:** □ Not Recommended  
 ▨ Recommended  
 ■ Best

**Parts for earlier models, not listed in this catalog are also available.**

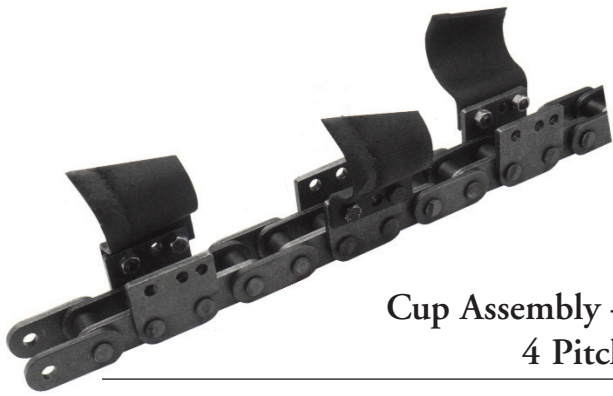

Cup Assembly –  
4 Pitch

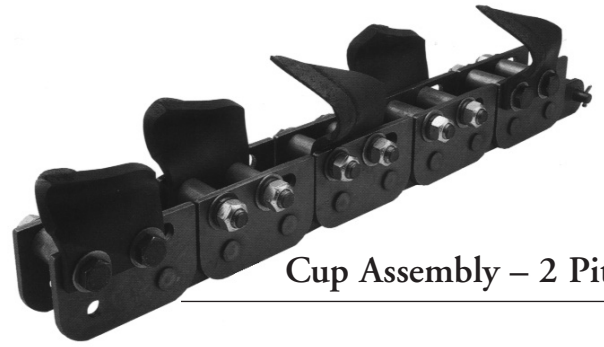

Cup Assembly – 2 Pitch

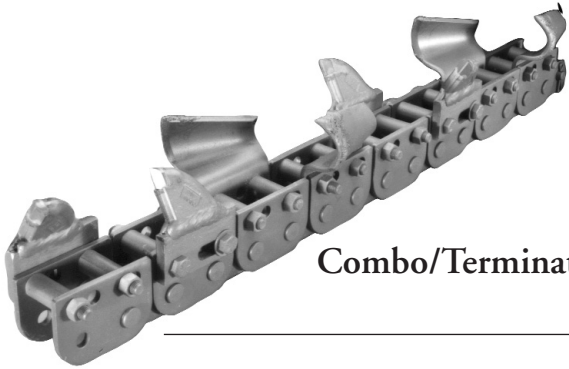

Combo/Terminator –  
Cup

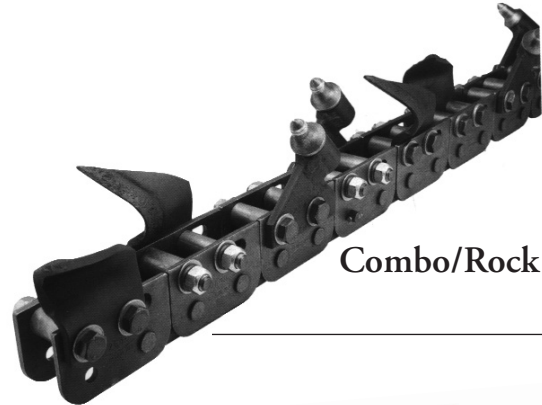

Combo/Rock & Frost  
Cup

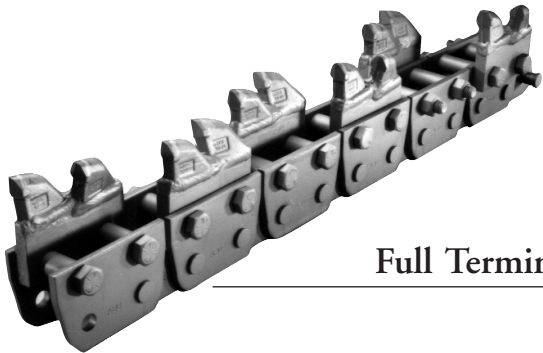

Full Terminator

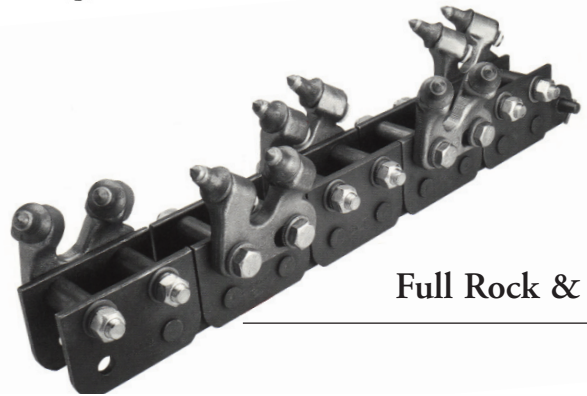

Full Rock & Frost

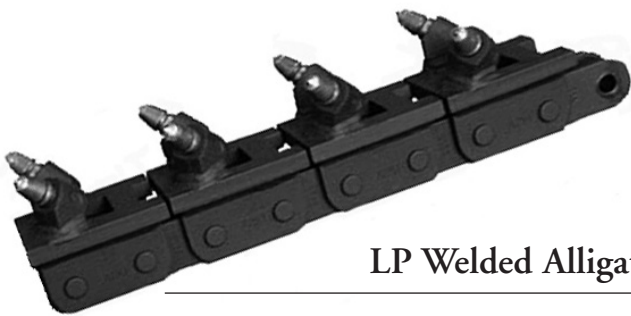

LP Welded Alligator

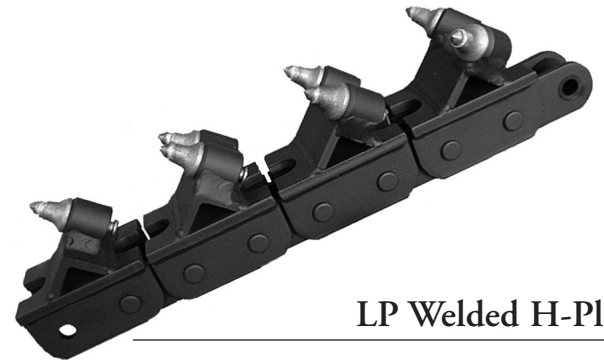

LP Welded H-Plate

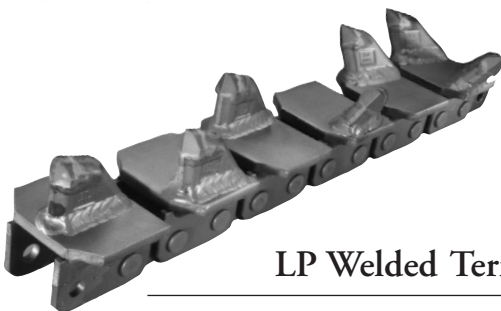

LP Welded Terminator

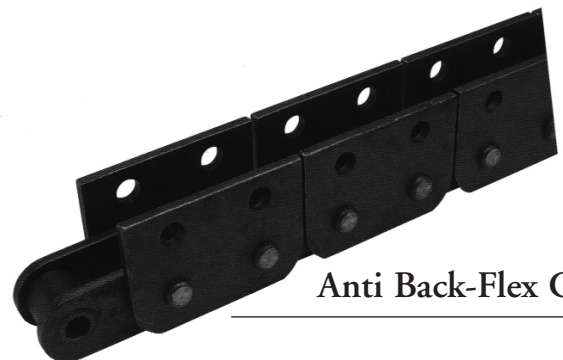

Anti Back-Flex Chains

## Ballantine, Inc. Smart Part Numbering System for Chain Assemblies

Ballantine's smart part numbering system has been developed to allow people to easily identify the various chain assemblies that are available and what suits specific applications. The diagram below explains what each section of the part number means.

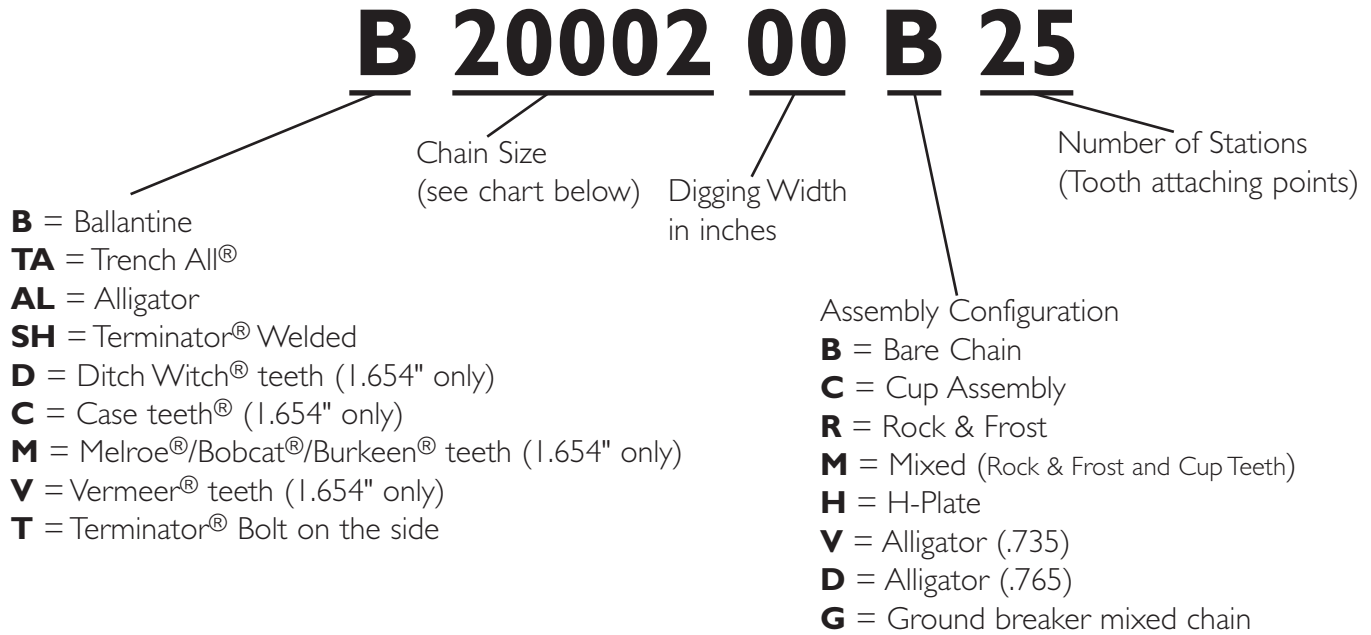

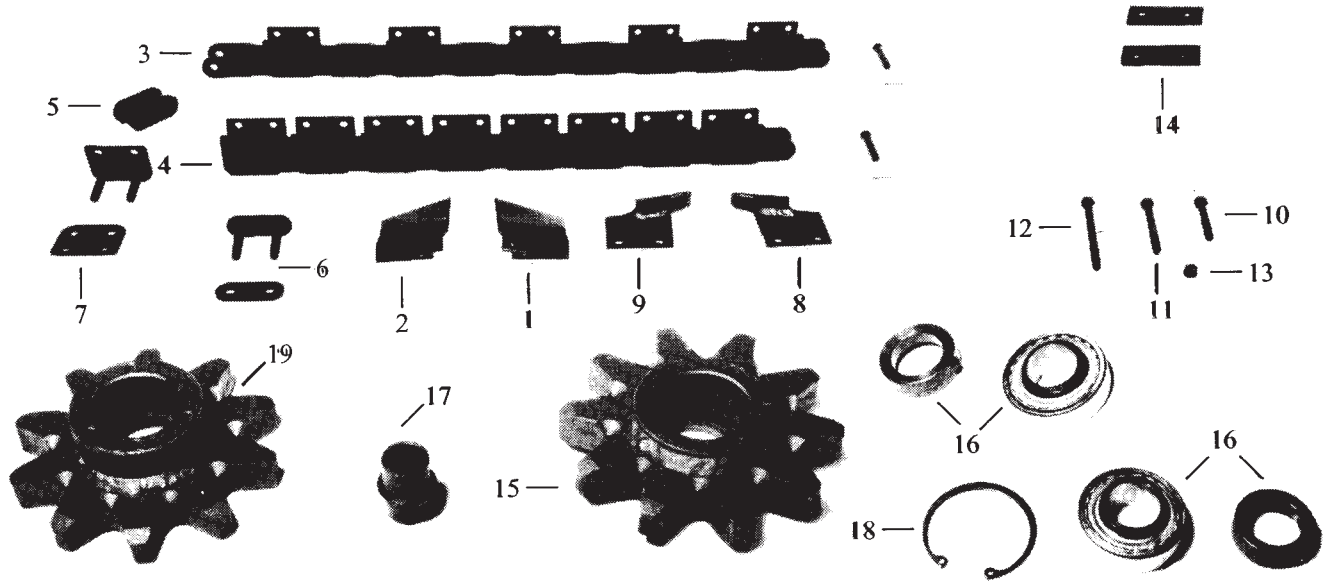

Ref. No.	Part No.	Description
1	V 53856002	Cutter, R.H.
2	V 53856001	Cutter, L.H.
N/S	V 253841001	Heavy-Duty Cutter, L.H.
N/S	V 253842001	Heavy-Duty Cutter, R.H.
10	V 354022	Bolt - 3/8" X 24 X 2 1/4", Grade #8
11	V 354024	Bolt - 3/8" X 24 X 2 1/2", Grade #8
12	V 354026	Bolt - 3/8" X 24 X 2 3/4", Grade #8
13	V 416001	Locknut - 3/8" X 24
14	V 53980001	Flat Spacer - 1/2" X 1 X 3"
15	V 54554003	Sprocket Assembly (Includes Reference #16, 17, 18)
16	V 57904001	Bearing
17	V 53573001	Spacer
18	V 602206	Snap Ring
19	V 53552001	Sprocket Drive
N/S	V 204931001	7" Idler Roller Assembly
3	V 53855068	Chain Standard 1.654
3	V 53855076	Chain Standard 1.654
3	V 53855084	Chain Standard 1.654
4	V 53855068D	2nd Chain Double Standard
4	V 53855076D	2nd Chain Double Standard
4	V 53855084D	2nd Chain Double Standard
5	V 57702001	Link Roller
6	V 57701001	Link Connector W / Keepers
7	V 57703001	Link - M2 Attachment W / Keepers
8	6655440	Ground Breaker, L.H.
9	6655441	Ground Breaker, R.H.
N/S	V 1074053	Spacer (Tooth Outside)
N/S	V 1074055	Spacer (Tooth Inside)

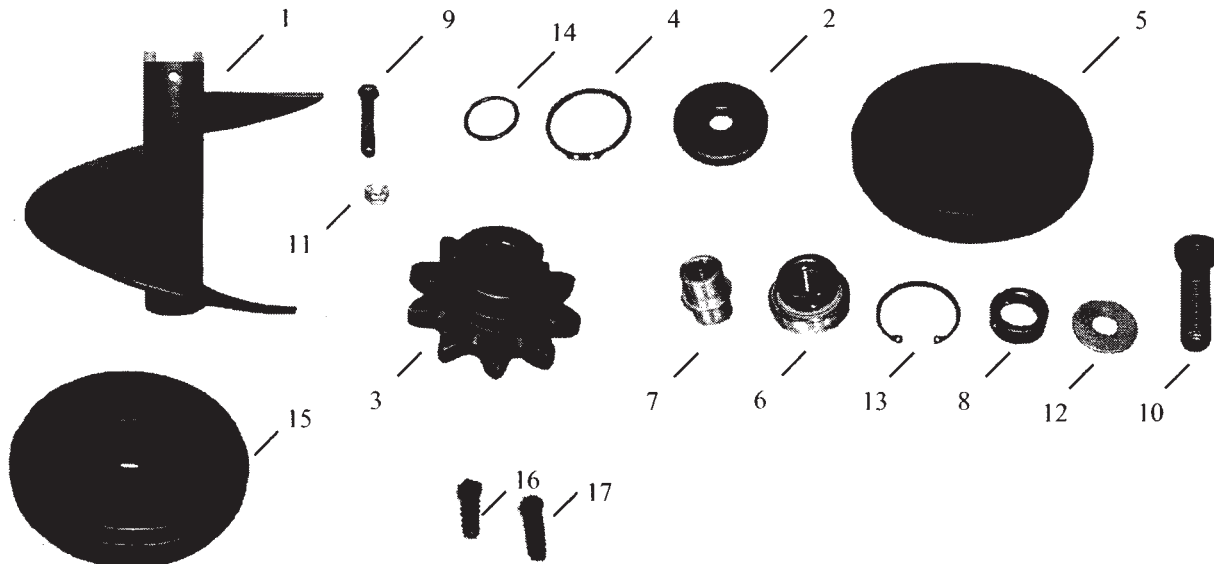

Ref. No.	Part No.	Description
1	V 220345001	Auger
2	V 220348001	Protector Seal
3	V 220359001	Sprocket Digger
4	V 224710001	Snap Ring - 3 5/8" External
5	V 226999001	End Idler - 7" (Also Known As Part No. 255507001)
6	V 230154001	Bearing - V1150 After SN2247, V1350 After SN337
N/S	V 237268001	7" End Idler Assembly (Inc. Ref. #5, 6, 7, 13)
7	V 252290001	Spacer - End Idler, V1150 After SN2247, V1350 After SN337
8	V 252291001	Spacer - End Idler
6	V 252300001	Bearing - End Idler, V1150 Before SN2247, V1350 Before SN337
9	V 354030	Bolt - 3/8" - 16 X 3" Hex, Grade #5
10	V 369030	Bolt 3/4" - 10 X 3" Hex, Grade #5
N/S	V 413001	Nut - 3/8" NC Hex Jam
11	V 416001	Nut - 3/8" NC SLTL
12	V 483025	Washer - 1 1/4" X 3/4" X 14 GA M.B.
N/S	V 522001	SSS - 1/4" - 28 X 1/4"
7	V 53573001	Spacer - End Idler, Prior to V1150 SN2247, Prior to V1350 SN338
N/S	V 586001	Zerk - 1/8" ST NPT Grease
N/S	V 598001	Zerk - 1/4" NF ST Grease
13	V 602206	Snap Ring - Int. 2 1/16"
14	V 51171001	O-Ring
15	V 204931001	7" End Idler Assembly (Inc. Ref. #6, 7, 13, 15)
16	V 549010	Screw - 3/8" X 16 X 1" Set
17	V 549012	Screw - 3/8" X 16 X 1 1/4" Set



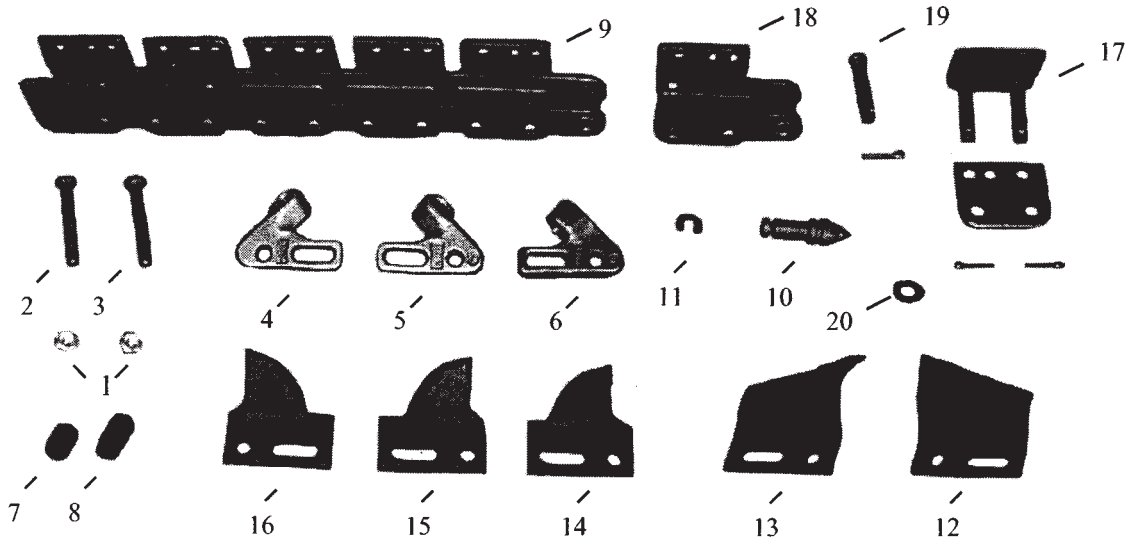

Ref. No.	Part No.	Description
1	V 416001	3/8" LN
2	382438	3/8" X 24 X 3 " Bolt for Mounting Rock &Frost, Terminator and Cups to Outside, Grade #8
3	38242128	3/8" X 24 X 2 1/2" Bolt for Mounting Rock & Frost and Cups to Inside, Grade #8
4	B 135317	Bolt-On Adapter L.H. Rotary Rock & Frost
5	B 135318	Bolt-On Adapter R.H. Rotary Rock & Frost
6	B 135316	Straight Rock & Frost
7	V 135999	Inside Tube Spacer for Cup Cutter Inside
8	B 138009	Tube Spacer - Long, Outside Mount
N/S	B 138010	Tube Spacer W / Rock & Frost Inside
9	B 225000B26	Bare Chain 2250, 52 Pins, 24" Depth
9	B 225000B30	Bare Chain 2250, 60 Pins, 30" Depth
9	B 225000B34	Bare Chain 2250, 68 Pins, 36" Depth
10	B 17	Rotary Bit
11	B 17D	Clip for Rotary Bit
12	V 253841001	Cup Cutter, L.H., Heavy-Duty
13	V 253842001	Cup Cutter, R.H., Heavy-Duty
14	V 228609001	Terminator Adapter Center (T165404C)
15	V 228611001	Terminator Adapter R.H. (T165404R)
16	V 228616001	Terminator Adapter L.H. (T165404L)
17	B 564815-2	Connecting Link
18	B 564633-2	Repair Section W/2 Pins and Keepers
19	B 208454	Chain Pin W/Keepers
20	38 FW	3/8" Flat Washer

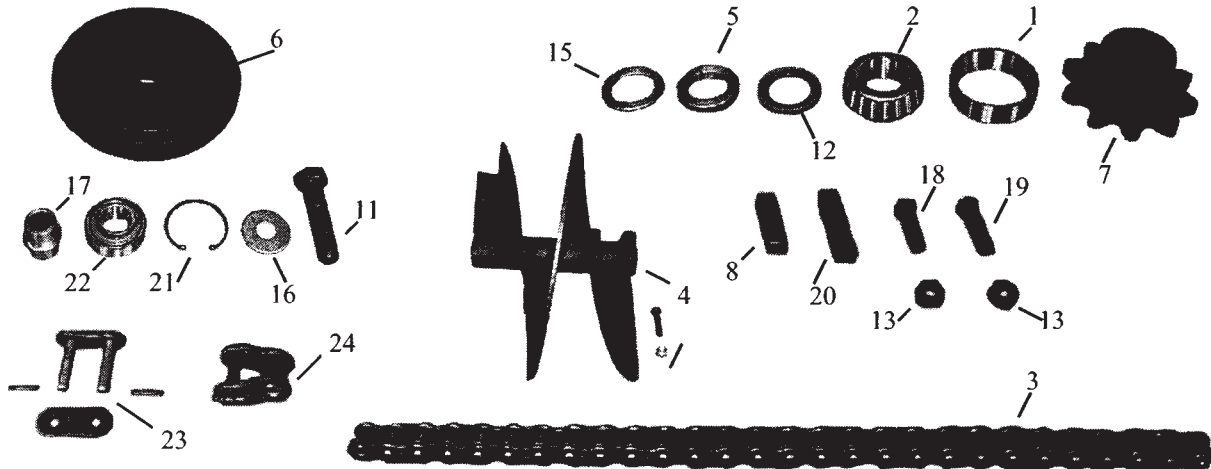

Ref. No.	Part No.	Description
1	V 1715039	Cup 1 3/4"
2	V 1716041	Bearing Cone 1 3/4"
3	V 1782060	Chain - 80 -1, 60 Pitches (Includes Conn.) Riveted
4	V 204800003	Auger Assembly (Inc. Two Bolts & Nuts)
5	V 204862001	Spacer - Head Shaft, 2 Req'd.
6	V 204931001	7" End Idler Assembly (Inc. Ref. #6, 17, 21, 22)
7	V 205366003	Drive Sprocket Assembly (Inc. Ref. #13, 18, 19)
8	V 205723001	Keyway - 3/8" X 3/8" X 1 3/8"
N/S	V 354030	Bolt - 3/8" X 16 X 3" Hex
10	V 366026	Bolt - 5/8" X 11 X 2 3/4", Grade #8
11	V 369030	Bolt - 3/4" X 10 X 3", Grade #8
12	V 3697001	Seal
13	V 412001	Nut - 3/8" X 16 Hex
N/S	V 416001	Nut - 3/8" X 1 Hex, Self-Locking
N/S	V 430001	Nut - 5/8" X 11 Locknut
15	V 483013	Washer - 2 1/2" X 1 3/4" X .038 M.B.
16	V 483025	Washer - 1 1/4" OD X 3/4" ID X 14 GA
17	V 53573001	Spacer - End Roller
18	V 549010	Screw - 3/8" X 16 X 1" Set
19	V 549012	Screw - 3/8" X 16 X 1 1/4" Set
20	V 579011	Keyway - 3/8" X 3/8" X 2
N/S	V 598001	Zerk - 1/4" NF Straight Grease
21	V 602206	Snap Ring - Int. 2 1/16"
22	V 57904001	Bearing
23	80 CL	#80 Connecting Link
24	80 OL	#80 Offset Link

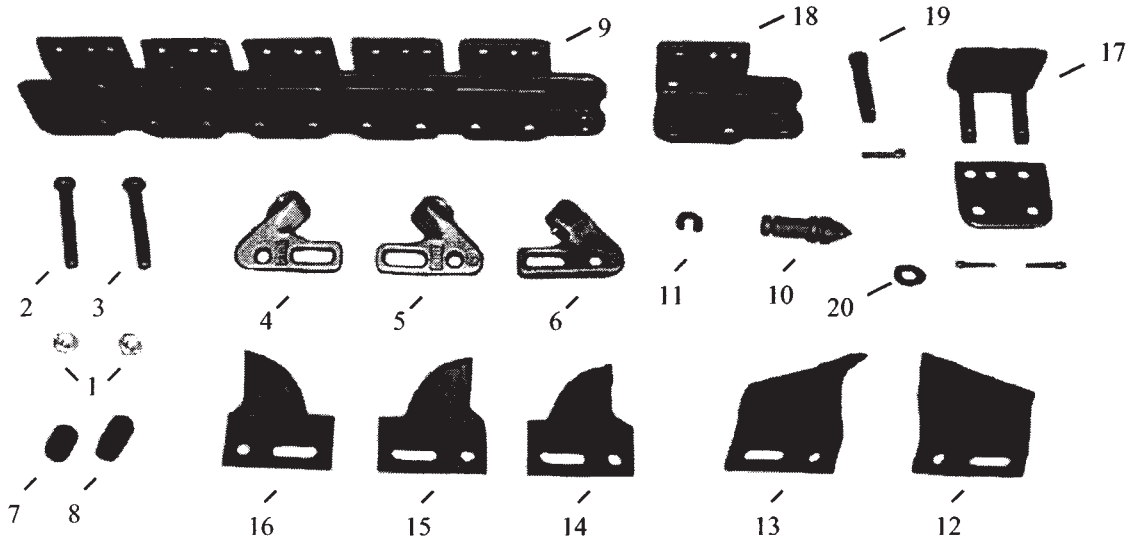

Ref. No.	Part No.	Description
1	V 416001	3/8" LN
2	382438	3/8" X 24 X 3" Bolt for Mounting R&F, Terminator and Cups to Outside, Grade #8
3	38242128	3/8" X 24 X 2 1/2" Bolt for Mounting R&F and Cups to Inside, Grade #8
4	B 135317	Bolt-On Adapter L.H. Rotary R&F
5	B 135318	Bolt-On Adapter R.H. Rotary R&F
6	B 135316	Straight R & F
7	V 135999	Inside Tube Spacer for Cup Cutter Inside
8	B 138009	Tube Spacer - Long, Outside Mount
N/S	B 138010	Tube Spacer W / Rock & Frost Inside
9	B 225000B26	Bare Chain 2250, 52 Pins, 24" Depth
9	B 225000B30	Bare Chain 2250, 60 Pins, 30" Depth
9	B 225000B34	Bare Chain 2250, 68 Pins, 36" Depth
10	B 17	Rotary Bit
11	B 17D	Clip for Rotary Bit
12	V 253841001	Cup Cutter, L.H., Heavy-Duty
13	V 253842001	Cup Cutter, R.H., Heavy-Duty
14	V 228609001	Terminator Adapter Center (T165404C)
15	V 228611001	Terminator Adapter R.H. (T165404R)
16	V228616001	Terminator Adapter L.H. (T165404L)
17	B 564815-2	Connecting Link
18	B 564633-2	Repair Section W/2 Pins and Keepers
19	B 208454	Chain Pin W/Keepers
20	38 FW	3/8" Flat Washer

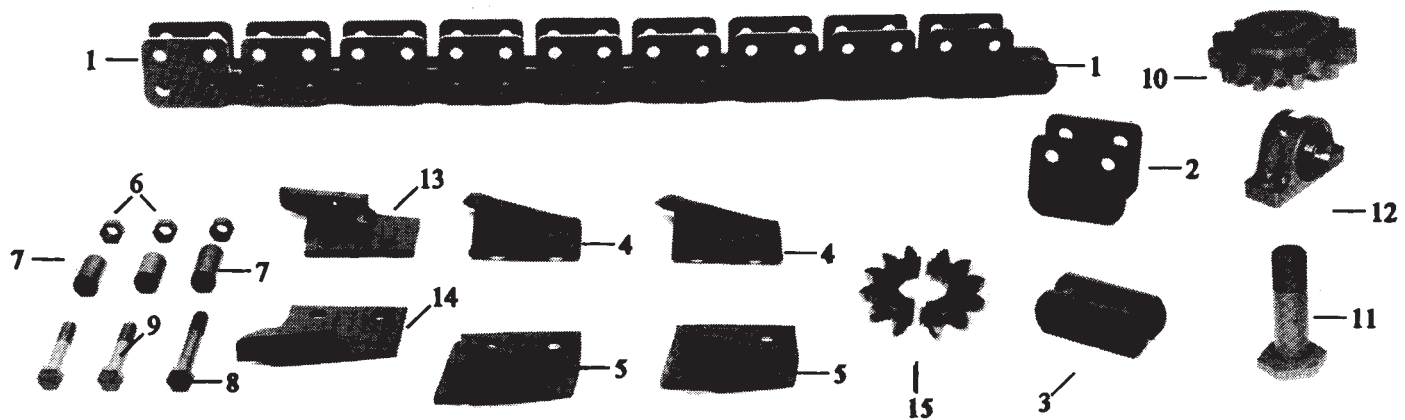

Ref. No.	Part No.	Description
1	V 3099050	Chain 8' 33"
2	V 3090005	Connecting Link W / Keepers
3	V 3088005	Roller Link
4	V 10641001	Cutter, L.H.
5	V 10641002	Cutter, R.H.
6	V 395001	Locknut - 1/2" X 20, Grade C
7	V 12074909	Tube Spacer, Tooth Mounted Outside
8	V 383032	Bolt - 1/2" X 20 X 3 1/4", Grade #8
9	V 383030	Bolt - 1/2" X 20 X 3", Grade #8
10	V 11973001	12T Idler Sprocket for V434 & V440
11	V 57294003	Grease Bolt
12	V 1700007	1 3/4" Pillow Block Bearing
13	V 135501	Ground Breaker, L.H.
14	V 135502	Ground Breaker, R.H.
15	V 16588003	12T Sprocket Split

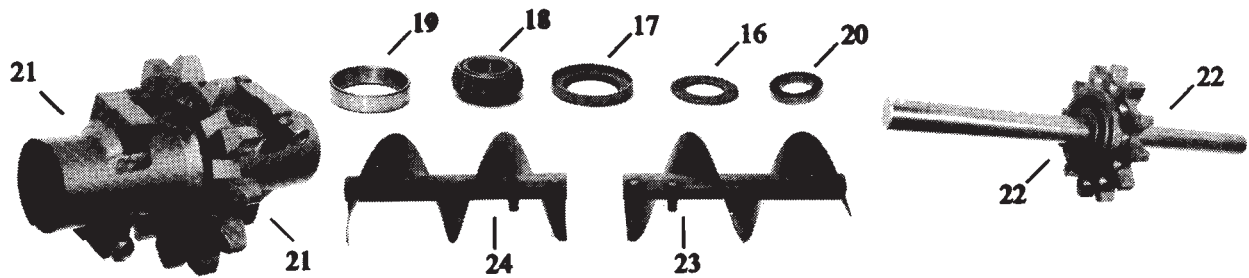

Ref. No.	Part No.	Description
16	V 489001	Washer
17	V 3958001	Seal
18	V 1716019	Bearing
19	V 1715019	Race
20	V 45261001	Backup Rings
21	V 11989003	12T Drive Sprocket for V434 & V440
22	V 11979001	12T Auger Sprocket for V434 & V440
23	V 24587004	Auger, R.H., 24" Long
24	V 24587003	Auger, L.H., 24" Long
N/S	V 3099082	Chain 13' 66"
N/S	V 3099084	Chain 14'
N/S	V 3099094	Chain 15' 66"
N/S	V 3099108	Chain 18'
N/S	V 3099112	Chain 18' 66"
N/S	V 3099066	Chain 11'
N/S	V 3099078	Chain 13'
N/S	V 3099092	Chain 15' 33"
N/S	V 200552003	Auger, L.H., 12" Long
N/S	V 200552004	Auger, R.H., 12" Long

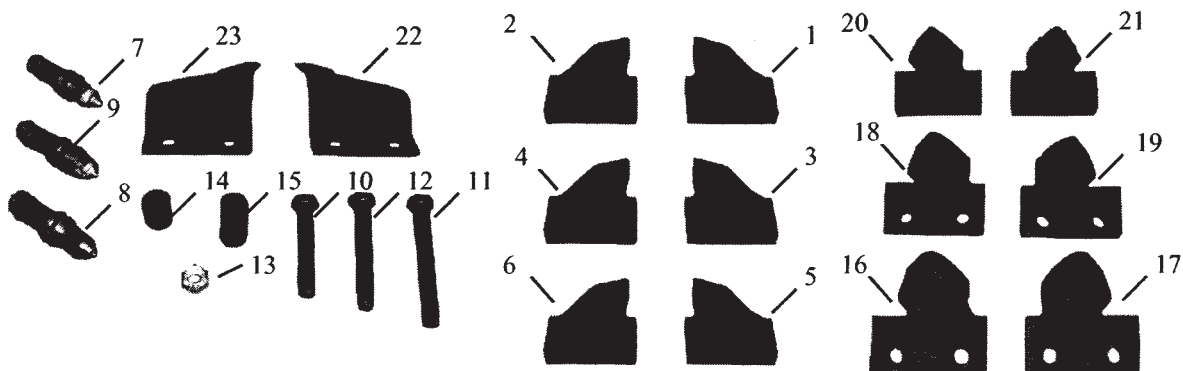

Ref. No.	Part No.	Description
1	T 20004LH	Terminator Adapter, L.H., Center - 4" Cut
2	T 20004RH	Terminator Adapter, R.H., Center - 4" Cut
3	T 20005LH	Terminator Adapter, L.H., 5" Cut
4	T 20005RH	Terminator Adapter, R.H., 5" Cut
5	T 20006LH	Terminator Adapter, L.H., 6" Cut
6	T 20006RH	Terminator Adapter, R.H., 6" Cut
7	735 CB	.735 Full Cap Bit, Carbide
8	735 HB	.735 Rockbuster Bit, Carbide
9	735 MB	.735 Half Cap Bit, Carbide
10	V 383030	1/2" X 20 X 3" Bolt, Grade #8, for Inside Mount Rotary & Terminator Adapter
11	V 383036	1/2" X 20 X 4 1/2" Bolt , Grade #8, for Outside Mount Rotary & Terminator Across Chain
12	V 383040	1/2" X 20 X 3 3/4" Bolt, Grade #8, for Outside Mount Rotary & Terminator Adapter
13	V 395001	Locknut - 1/2" X 20
14	V 12073909	Chain Spacer, Inside Mount Rotary Adapter, Terminator
15	V 12074909	Chain Spacer, Outside Mount Rotary Adapter, Cup, Terminator
16	V 13923001	Rotary Adapter R.H. CC - 4"
17	V 13923002	Rotary Adapter L.H. CC - 4"
18	V 13925001	Rotary Adapter R.H. 5"
19	V 13925002	Rotary Adapter L.H. 5"
20	V 13926001	Rotary Adapter R.H. 6"
21	V 13926002	Rotary Adapter L.H. 6"
22	V 253837001	Cup Cutter L.H. (Old #V 10641001)
23	V 253838002	Cup Cutter R.H. (Old #V 10641002)

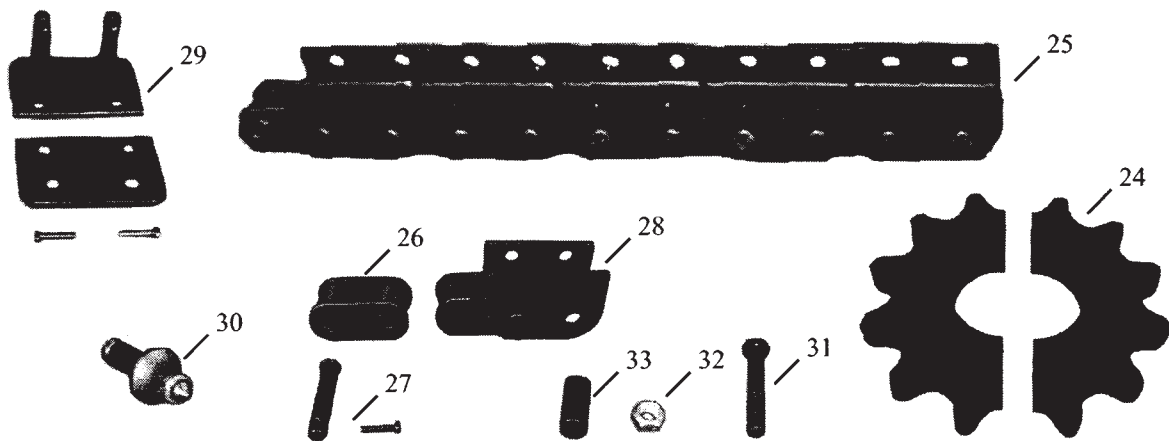

Ref. No.	Part No.	Description
24	V 203601001	Sprocket Drive 12T 2" Pitch
25	B 296000B33	Bare Chain 2960, 66 Pins, 38" Depth
25	B 296000B39	Bare Chain 2960, 78 Pins, 48" Depth
25	B 296000B45	Bare Chain 2960, 90 Pins, 48" Depth
25	B 296000B46	Bare Chain 2960, 92 Pins, 60" Depth
26	TA 2043RL	Roller Link, 2960 Chain
27	TA 2043PC	Chain Pin, Includes Keeper Pin
28	TA 2043RPL	Repair Link, Includes 2 Pin & Keepers
29	TA 2043CL	Connecting Link
30	735CRFN	Bit W / Clip, Umbrella Style
31	V 382032	Bolt - 7/16" X 20 X 3 1/4", Grade #8, 6 Req'd.
32	V 15354001	Nut - 7/16" X 20, Grade #8
33	V 12074909	Tube Spacer

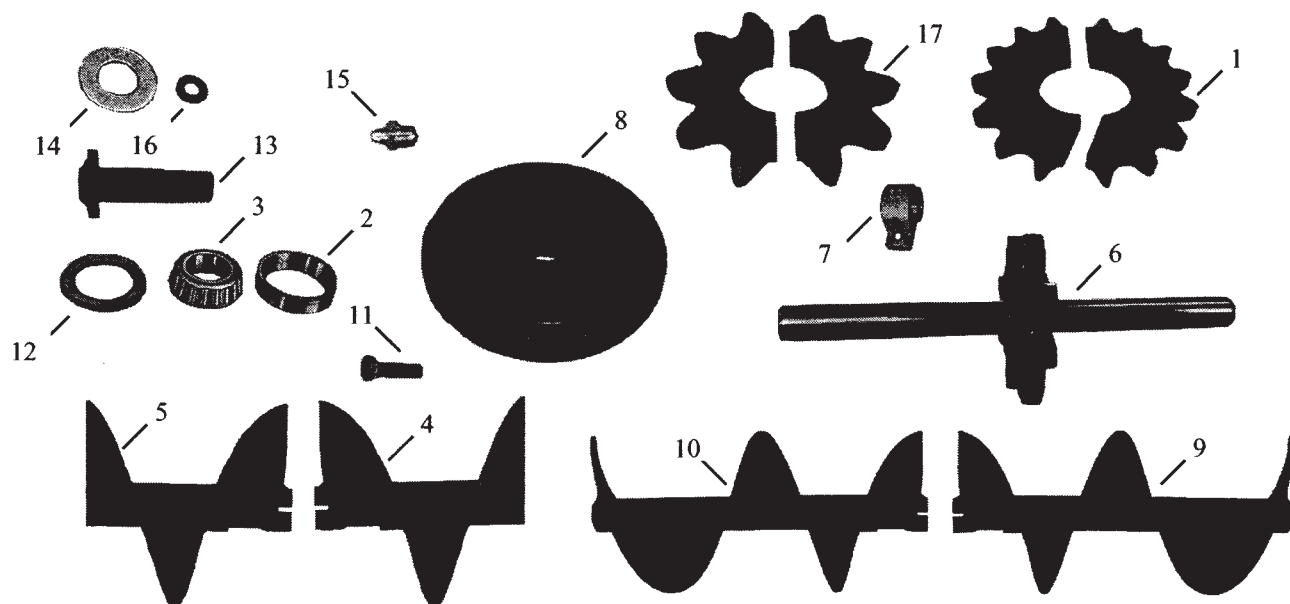

Ref. No.	Part No.	Description
1	V 21000001	Drive Sprocket for 2960 Chain, 15 Tooth, 2" Pitch
2	V 1715019	Cup - 1 1/4"
3	V 1716019	Cone - 1 1/4"
4	V 200552003	12" Auger Assembly (L.H.)
5	V 200552004	12" Auger (R.H.)
6	V 248693001	Sprocket - Auger Drive (Use W/3990 Chain)
7	V 220700001	Bearing - 1 3/4" Pillow Block
8	V 223643001	End Idler Assembly - 15" (3990 Chain) (Includes Two of Ref. #2)
9	V 24587003	Auger Assembly - 24" (L)
10	V 24587004	Auger Assembly - 24" (R)
N/S	V 358022	Pillow Block Bolt - 1/2" - 13 X 2 1/4" Grade #5 Hex
11	V 366030	Auger Bolt - 5/8" - 11 X 3" Grade #5 Hex for Auger
12	V 3958001	Seal
13	V 40070001	Bolt - 1 1/4" X 4 1/4" Boom Idler
14	V 483027	Washer - 2 1/4" X 1 1/4" X 14 GA M.B.
15	V 586001	Zerk - 1/8" Straight NPT Grease
16	V 86510001	Washer - 1/2" Flt Hardened
17	V 204052001	Drive Sprocket for 3990 Chain, 10 Tooth, 3" Pitch



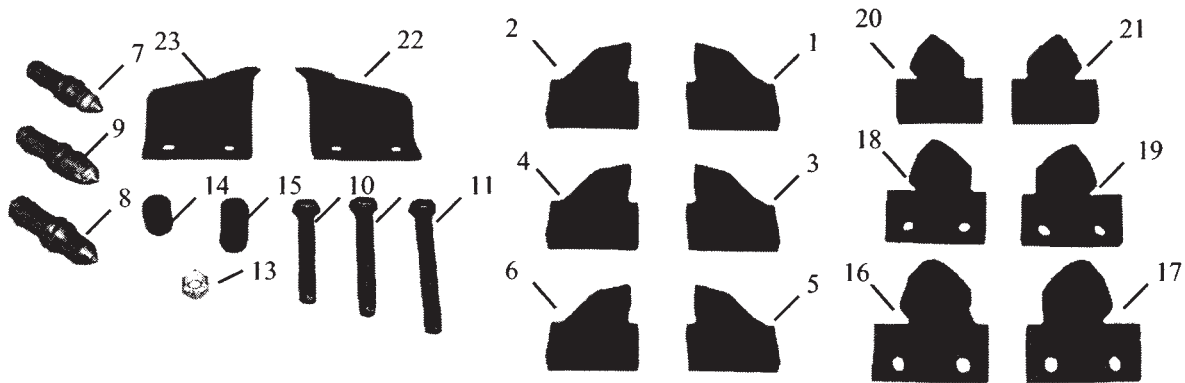

Ref. No.	Part No.	Description
1	T 20004LH	Terminator Adapter L.H., CC - 4" Cut
2	T 20004RH	Terminator Adapter R.H., CC - 4" Cut
3	T 20005LH	Terminator Adapter L.H., 5" Cut
4	T 20005RH	Terminator Adapter R.H., 5" Cut
5	T 20006LH	Terminator Adapter L.H., 6" Cut
6	T 20006RH	Terminator Adapter R.H., 6" Cut
7	735 CB	.735 Half Cap Bit, Carbide
8	735 MB	.735 Full Cap Bit, Carbide
9	735 HB	.735 Rockbuster Bit, Carbide
10	V 383030	Bolt - 1/2" X 20 X 3", Grade #8, for Inside Mount Rotary & Terminator, Cups
11	V 383044	Bolt - 1/2" X 20 X 4 1/2", Grade #8, for Outside Mount Rotary & Terminator Across Chain
12	V 383036	Bolt - 1/2" X 20 X 3 3/4", Grade #8, for Outside Mount Rotary & Terminator
13	V 395001	Locknut - 1/2" X 20
14	V 12073909	Chain Spacer, Inside Mount Rotary, Terminator
15	V 12074909	Chain Spacer, Outside Mount Rotary, Terminator & Cup
16	V 13923001	Rotary Adapter R.H. CC - 4"
17	V 13923002	Rotary Adapter L.H. CC - 4"
18	V 13925001	Rotary Adapter R.H. 5"
19	V 13925002	Rotary Adapter L.H. 5"
20	V 13926001	Rotary Adapter R.H. 6"
21	V 13926002	Rotary Adapter L.H. 6"
22	V 253837001	Cup Cutter L.H. (Old #10641001)
23	V 253838002	Cup Cutter R.H. (Old #10641002)

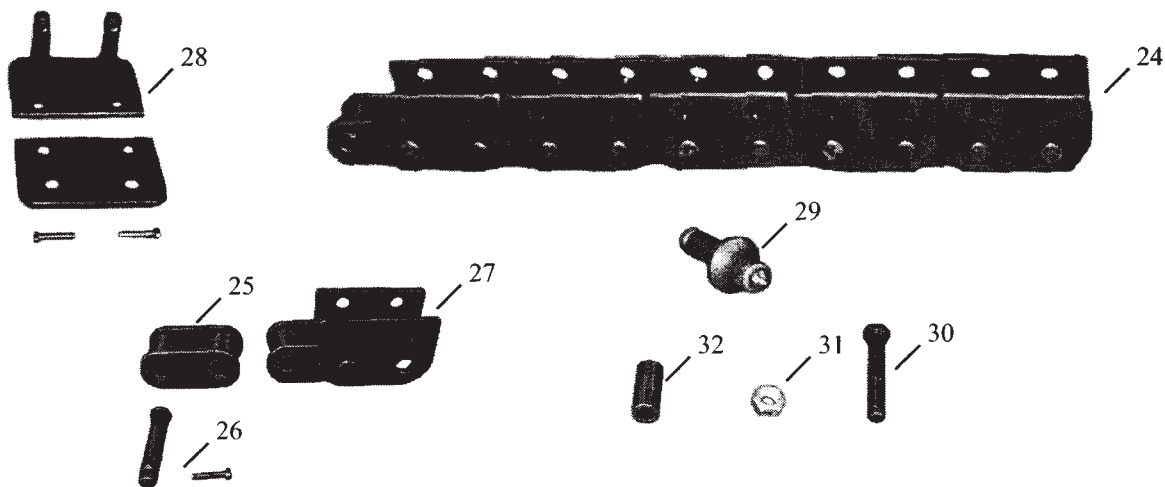

Ref. No.	Part No.	Description
24	B 296000B39	Bare Chain 2960, 78 Pins, 40" Depth
24	B 296000B45	Bare Chain 2960, 90 Pins, 48" Depth
24	B 296000B51	Bare Chain 2960, 102 Pins, 60" Depth
25	B 2960RL	Roller Link
26	B 2960RPL	Chain Pin Includes Keeper Pin
27	B 2960RPL	Repair Link Includes 2 Pins & Keepers
28	B 2960CL	Connecting Link
29	735CRFN	Bit W / Clip, Umbrella Style
30	V 382032	Bolt - 7/16" X 20 X 3 1/4", Grade #8, 6 Req'd.
31	V 15354001	Nut - 7/16" X 20, Grade #8
32	V 12074909	Tube Spacer

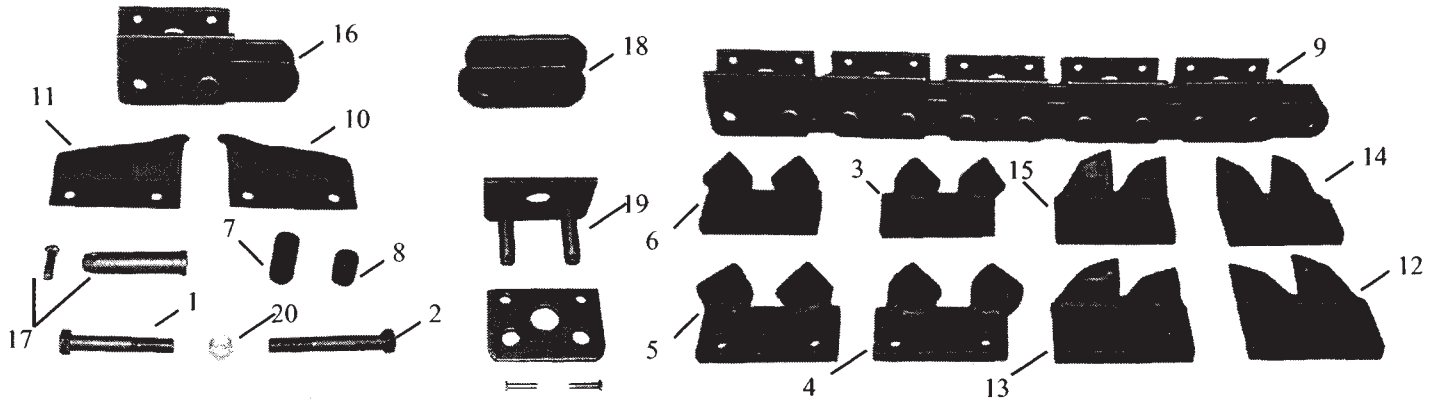

Ref. No.	Part No.	Description
1	V 12203148	1/2" X 3 1/4" Bolt for Inside Mount Terminator & Rotary
2	V 122048	1/2" X 4" Bolt for Outside Mount Terminator & Rotary
3	V 15183002	Rotary Adapter, L.H., MI
4	V 15183001	Rotary Adapter, R.H., MJ
5	V 15184002	Rotary Adapter, L.H., MG
6	V 15184001	Rotary Adapter, R.H., MH
N/S	V 15181002	Rotary Adapter, L.H., MK
N/S	V 15181001	Rotary Adapter, R.H., ML
7	V 6092	Tube Spacer Cup, Terminator, Rotary Outside Mount, Long
8	V 135953	Tube Spacer Terminator, Rotary Inside Mount, Short
9	3990SCP00052	Bare Chain 3990, 52 Pins, 40" Depth
9	3990SCP00060	Bare Chain 3990, 60 Pins, 48" Depth
9	3990SCP00068	Bare Chain 3990, 68 Pins, 60" Depth
10	V 253839001	Cup Cutter, L.H. (Old # V 10638-001)
11	V 253840001	Cup Cutter, R.H. (Old # V 10038-002)
12	V 228629001	Terminator Adapter, 3990 Chain, 6", L.H.
13	V 228630001	Terminator Adapter, 3990 Chain, 6", R.H.
14	V 228631001	Terminator Adapter, 3990 Chain, 8", L.H.
15	V 228632001	Terminator Adapter, 3990 Chain, 8", R.H.
16	B 3990RPL	Repair Section W / 2 Pins & Keepers
17	B 3990PC	Chain Pin W / Keeper
18	3990RL	Roller Block
19	3990CL	Connecting Link W / Keeper
20	1220LN	Nut

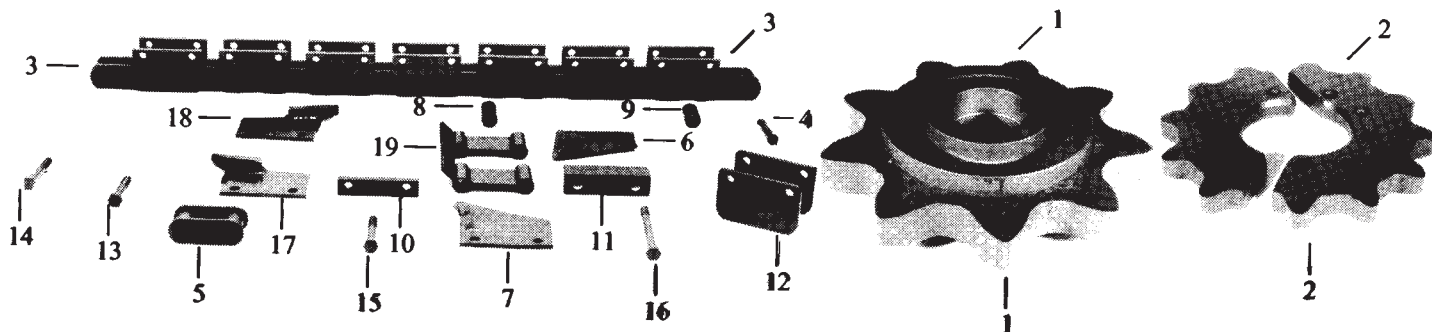

Ref. No.	Part No.	Description
1	V 39022001	9T Idler Sprocket (Old #4864)
2	V 40233-001	12T Drive Sprocket (Old #6391)
3	V 3095062	Chain 15, 6" Long (Old #6094)
4	V 10816001	Chain Pin W / Cotter (Old #6078)
5	V 6074	Roller Link
6	V 10638002	Cutter, R.H. (Old #1060A)
7	V 10638001	Cutter, L.H. (Old #1061A)
8	V 12074909	Tube Spacer (Old #6091)
9	V 12075909	Tube Spacer (Old #6092)
10	V 15180001	Flat Spacer - 1/2" X 1" X 5" (Old #2835)
11	V 15179001	Flat Spacer - 1 1/2" X 1" X 5" (Old #2836)
12	V 6087	Connecting Link
13	V 383034	Bolt - 1/2" 20 X 3 1/2", Grade #8
14	V 383040	Bolt - 1/2" X 20 X 4", Grade #8
15	V 383-042	Bolt - 1/2" X 20 X 4 1/4", Grade #8
16	V 383-052	Bolt - 1/2" X 20 X 5 1/4", Grade #8
17	V 501	Ground Breaker, L.H.
18	V 502	Ground Breaker, R.H.
19	V 9834	10" Double Spacer
N/S	V 9835	12" Double Spacer

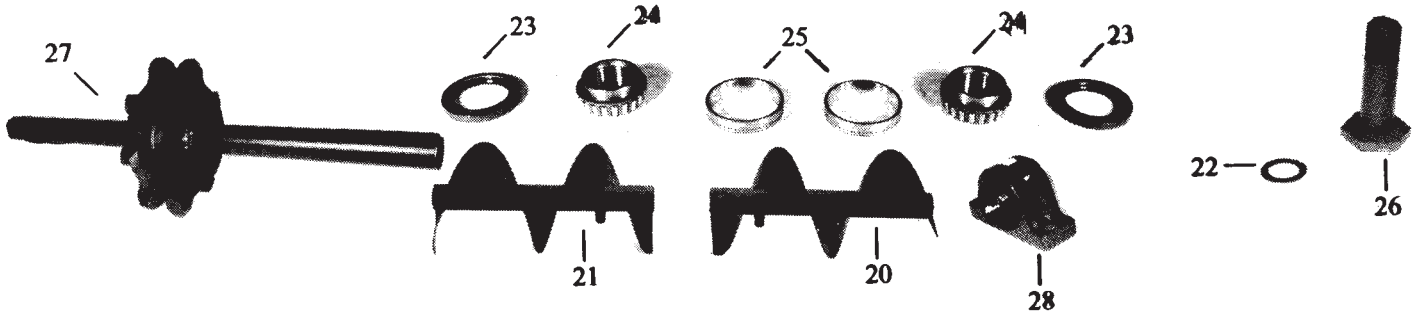

Ref. No.	Part No.	Description
20	V 24587004	Auger, R.H. (Old #934), 24" Long
21	V 24587003	Auger, L.H. (Old #923), 24" Long
22	V 489001	Washer (Old #204)
23	V 3958-001	Seal (Old #207)
24	V 1716-019	Cone (Old #206)
25	V 1715-019	Cup (Old #202)
26	V 40070-001	Grease Bolt (Old #6191)
27	V 47896-001	9T Auger Sprocket (Old #5124)
28	V 38537-001	1 3/4" Pillow Block Bearing (Old #4276)
N/S	V 3095-090	Chain 22' 6" Long
N/S	V 39982-001	Chain 17' 6" Long (Old #6084)
N/S	V 39984-001	Chain 20' (Old # 6086)
N/S	V 395001	1/2" X 20 Grade C Locknut

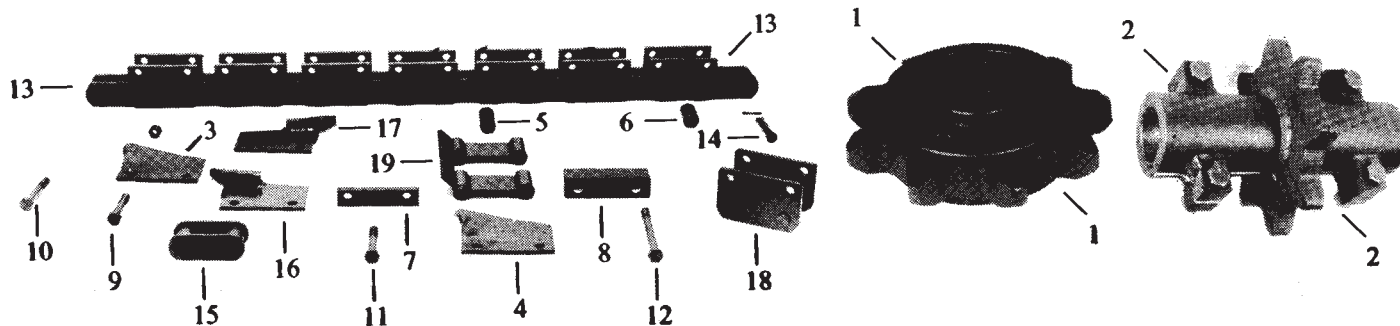

Ref. No.	Part No.	Description
1	V 16179	9T Idler Sprocket (Old #T4684)
2	V 10125	8T Drive Sprocket, 2 3/16" Bore (Old #423) (V 43132001)
3	V 10638002	Cutter, R.H. (Old #1060A)
4	V 10638001	Cutter, L.H. (Old #1061A)
5	V 6091	Tube Spacer, Tooth Mounted Inside
6	V 6092	Tube Spacer, Tooth Mounted Outside
7	V 2835	Spacer - 1/2" X 1" X 5"
8	V 2836	Spacer - 1 1/2" X 1 1/4" X 5"
9	V 383034	Bolt - 1/2" X 20 X 3 1/2", Grade #8 (Old #7048)
10	V 383042	Bolt - 1/2" X 20 X 4 1/4", Grade #8 (Old #7244)
11	V 383040	Bolt - 1/2" X 20 X 4", Grade #8 (Old #7044)
12	V 383052	Bolt - 1/2" X 20 X 5 1/4", Grade #8 (Old #7555)
13	V 10140	1957 Chain for 40" Boom V434
14	V 6078	Chain Pin W / Keeper
15	V 6074	Roller Link
16	V 501	Ground Breaker, L.H.
17	V 502	Ground Breaker, R.H.
18	V 6087	Connecting Link for 1957M Chain W / Keepers
19	V 9834	10" Double Spacer
N/S	V 9835	12" Double Spacer

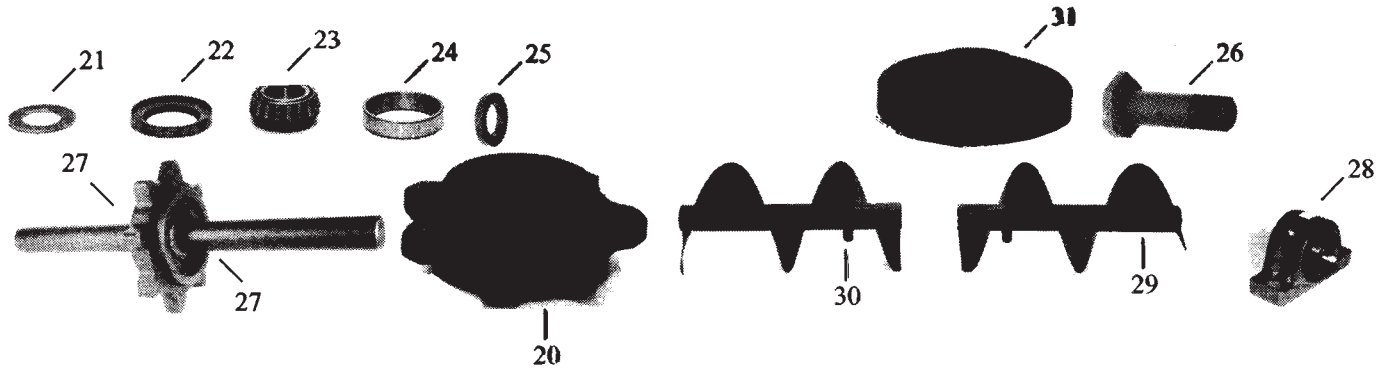

Ref. No.	Part No.	Description
20	V 212EE	7T Idler Sprocket (For M30 & M437A)
21	V 204	1/4" Washer
22	V 207	Seal
23	V 206	Bearing
24	V 202	Race
25	V 12979	Backup Rings
26	V 3932	Grease Bolt
27	V 16053	8T Auger Sprocket (Old #955A) (V 47342001)
28	V 4276	Pillow Block Bearing - 1 3/4" Bore
29	V 934A	Auger, R.H.
30	V 923A	Auger, L.H.
31	V 201	7" Idler Roller (V 35288001)
N/S	V 6082	1957M Chain for 48" Boom, M30 & M437
N/S	V 6085	1957M Chain for 60" Boom, M30 & M437
N/S	V 6086	1957M Chain for 60" Boom, M30 & M437
N/S	V 6094	1957M Chain for 48" Boom, V434
N/S	V 7588	1957M Chain for 40" Boom, M30 & M 437

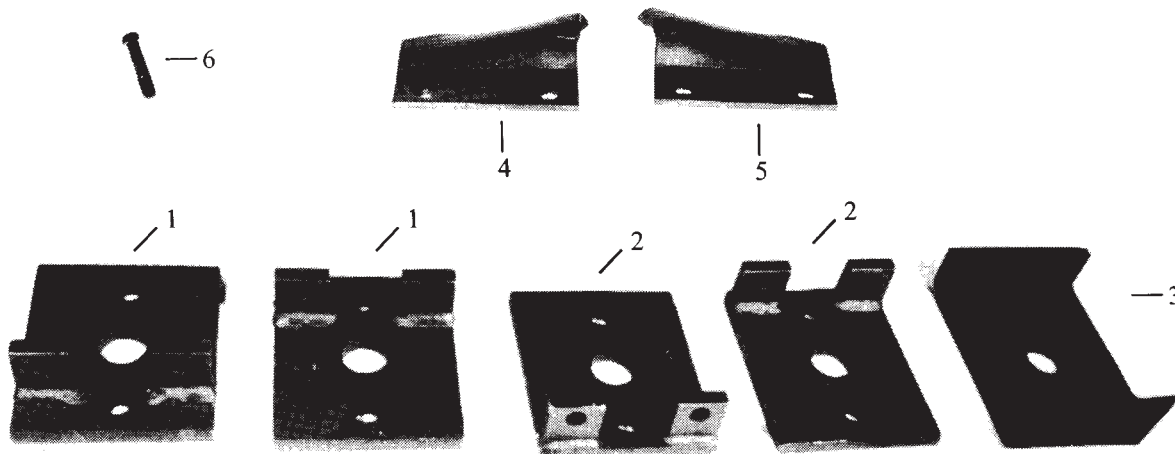

Ref. No.	Part No.	Description
1	V 15159-001	Cutter Base 6"
2	V 15162-001	Cutter Base 8"
3	V 15163-001	Cutter Base 10" Double
N/S	V 15166-001	Cutter Base 12" Double
4	V 10638-00	Cutter, R.H.
5	V 10638-00	Cutter, L.H.
6	V 10816	Pin W / Cotter
N/S	V 383-012	Bolt For Tooth - 1/2" X 20 X 1 1/4", Grade #8
N/S	V 384-014	Bolt For Base Plate - 5/8" X 18 X 1 1/2", Grade #8
N/S	V 395-001	1/2" X 20 Locknut
N/S	V 396-001	5/8" X 18 Locknut



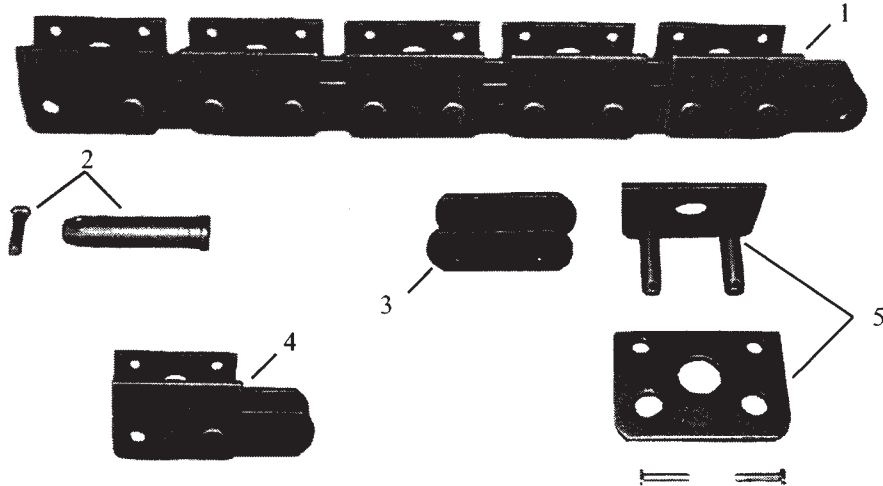

Ref. No.	Part No.	Description
1	B 3990M00B35	Bare Chain 3990, 70 Pins, 60" for PTS 5800, TR 5800 & TTR 5800
1	B 3990M00B33	Bare Chain 3990, 66 Pins, 48" for HTR 5800
1	B 3990M00B37	Bare Chain 3990, 74 Pins, 60" for HTR 5800
1	B 3990M00B31	Bare Chain 3990, 62 Pins, 48" for PTS 5800, TR 5800 & TTR 5800
2	B 3990PC	Chain Pin & Cotter
3	B 3990RL	Roller Link 3990
4	B 3990RPL	Repair Link 3990 W / 2 Pins & Keepers
5	B 3990CL	Connecting Link 3990 W / Keepers

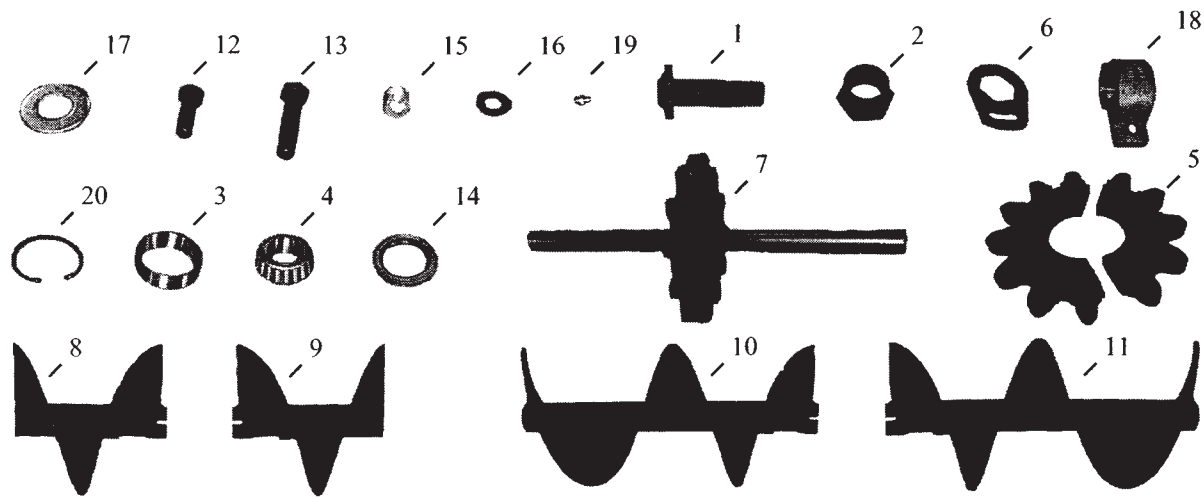

Ref. No.	Part No.	Description
1	V 14677003	Bolt Assembly - Grease
2	V 14731001	Nut - Idler
3	V 1715021	Timken Cup - 1 3/4"
4	V 1716021	Timken Cone - 1 3/4"
5	V 19910001	Sprocket Assembly - 12T Drive, 2134
6	V 204296001	Nut Retainer
7	V 248696001	Sprocket - 12T Auger Drive, 2134
8	V 203542004	12" R.H. Auger
9	V 203542003	12" L.H. Auger
10	V 203289004	24" R.H. Auger
11	V 203289003	24" L.H. Auger
12	V 358010	Bolt - 1/2" - 13 X 1" Grade #5 Hex
13	V 386034	3/4" - 16 X 3 1/2" Grade #8 Hex Bolt
14	V 3972001	Seal
15	V 398001	Nut - 3/4" X 16 Grade #8 SLTL
16	V 480011	Washer - 1/2" S/T Lock
17	V 483015	Washer - 2 1/2" X 1 3/4" X 14 GA M.B.
N/S	V 485011	1/2" Flat Washer
N/S	V 85706001	Washer - 5/8" for Pillow Block Bearing
N/S	V 430001	Locknut - 5/8" for Pillow Block Bearing
N/S	V 366030	Bolt - 5/8" X 3" for Pillow Block Bearing
18	V 65945001	1 3/4" Pillow Block W / 5/8" Holes
19	V 598001	Zerk - 1/4" NF ST Grease
20	V 602312	Snap Ring - Int. 3 1/8"

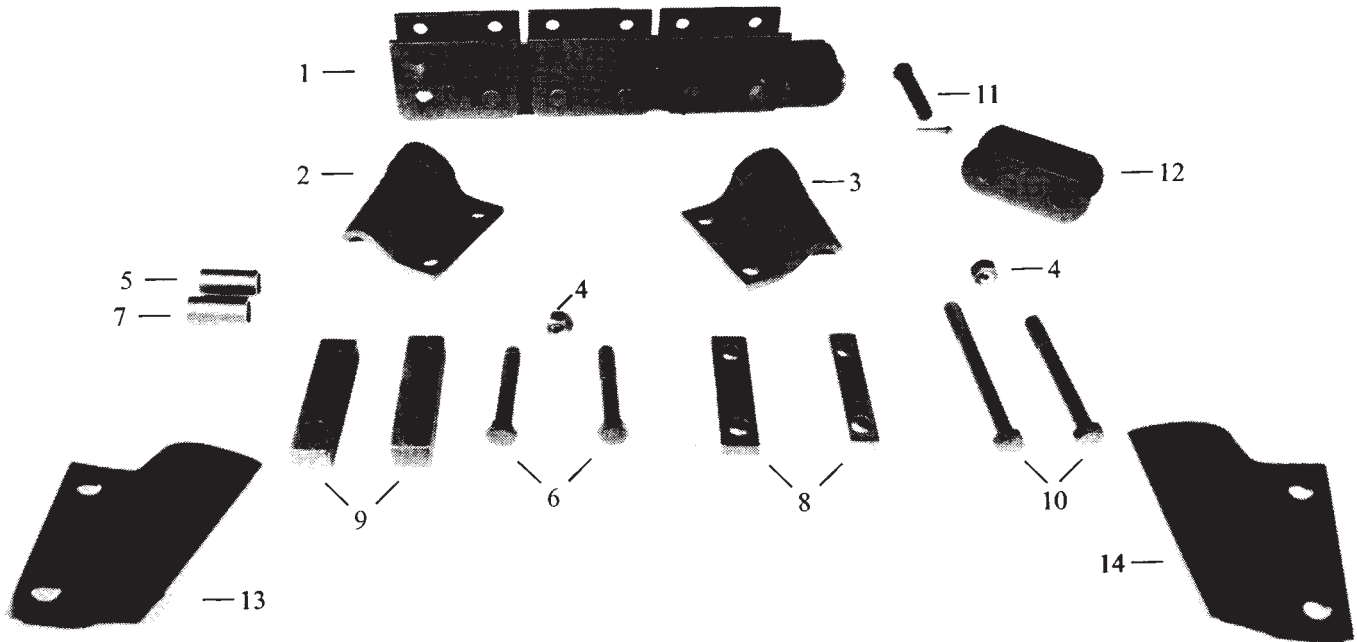

Ref. No.	Part No.	Description
1	V 13769054	Chain 13' 6"
10	V 384052	Bolt - 5/8" X 18 X 5 1/4", Grade #8
11	V 13774001	Pin W/ Cotter
12	V 3088001	Roller Link
13	V 203754001	Cutter, L.H. (Low Profile)
14	V 203754002	Cutter, R.H. (Low Profile)
2	V 10642002	Cutter, R.H.
3	V 10642001	Cutter, L.H.
4	V 396001	5/8" X 18 Locknut
5	V 1083023	Tube Spacer - 1 1/8" OD X 11/16" ID X 1 13/16"
6	V 284042	Bolt - 5/8" X 18 X 4 1/4", Grade #8
7	V 1083021	Tube Spacer - 1 1/8" OD X 11/16" X 2 3/16"
8	V 15658001	Space Cutter - 1/2" X 1 1/4" X 5"
9	V 15659001	Space Cutter - 1 1/2" X 1 1/4" X 5"
N/S	V 13769062	2134M Chain, 3 Pitch, 15' 6"
N/S	V 13769070	Chain 17' 6"
N/S	V 13769076	Chain 19'
N/S	V 13769080	Chain 20'
N/S	V 13769090	Chain 22' 6"
N/S	V 19910001	12T Split Drive for M475
N/S	V 206170001	12T Auger Sprocket & Shaft for M475

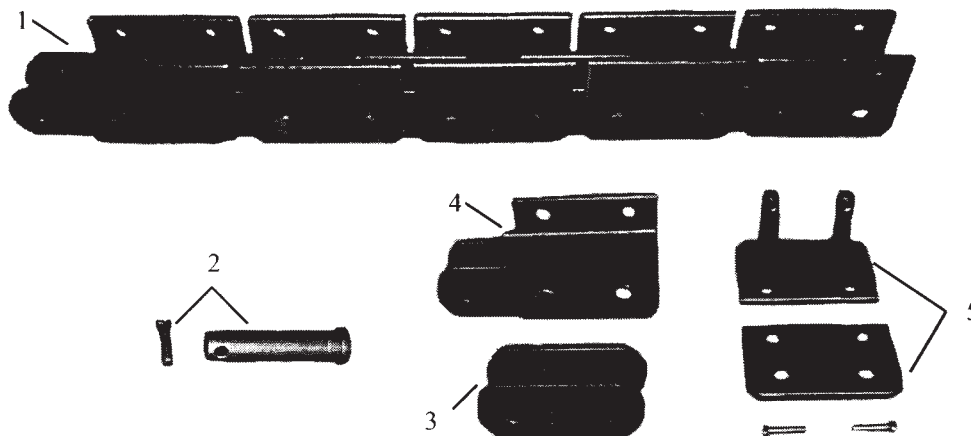

Ref. No.	Part No.	Description
1	B 2134M00B31	Bare Chain 2134, 48" for PTS 5800, TR 5800 & TTR 5800
1	B 2134M00B33	Bare Chain 2134, 48" for HTR 5800
1	B 2134M00B35	Bare Chain 2134, 60" for PTS 5800, TR 5800 & TTR 5800
1	B 2134M00B37	Bare Chain 2134, 60" for HTR 5800
2	B 2134CP	Chain Pin W /-Keeper
3	B 2134MRL	Roller Link 2134
4	B 2134MRPL	Repair Link W / 2 Chain Pins & Keepers
5	B 2134MCL	Connecting Link W / Keeper Pins

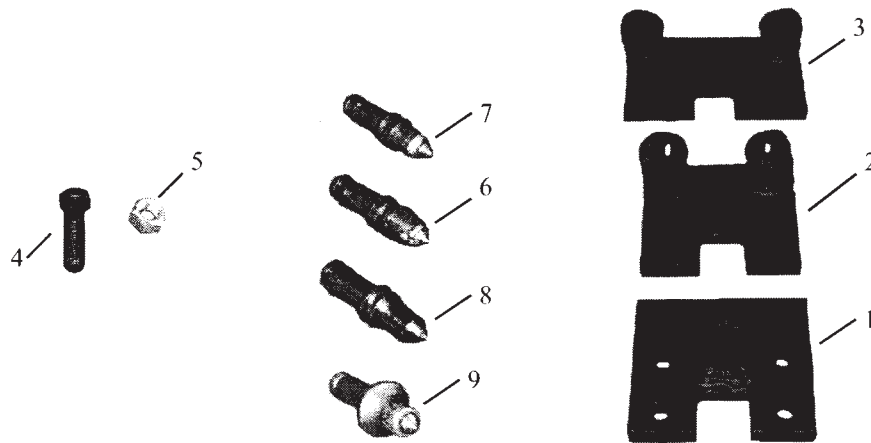

Ref. No.	Part No.	Description
1	V 15491001	Rock & Frost Base Plate. Center Cut
N/S	V 15493001	Rock & Frost Base Plate. 3"
2	V 66368001	Rock & Frost Base Plate. 4"
N/S	V 66370001	Rock & Frost Base Plate. 5"
N/S	V 66371001	Rock & Frost Base Plate. 6"
N/S	V 66372001	Rock & Frost Base Plate. 7"
N/S	V 66373001	Rock & Frost Base Plate. 8"
N/S	V 66374001	Rock & Frost Base Plate. 9"
N/S	V 15504001	Rock & Frost Base Plate. 10"
N/S	V 15505001	Rock & Frost Base Plate. 11"
3	V 15507001	Rock & Frost Base Plate. 12"
4	V 384020	Base Plate Bolt 5/8" X 18 X 2", Grade #8
5	V 396001	Base Plate Nut 5/8" X 18 Locknut
6	735 HB	.735 Rockbuster Bit
7	735 CB	.735 Full Cap Bit
8	735 MB	.735 Half Cap Bit
9	735 CRFN	.735 Bit W / Clip. Umbrella Style

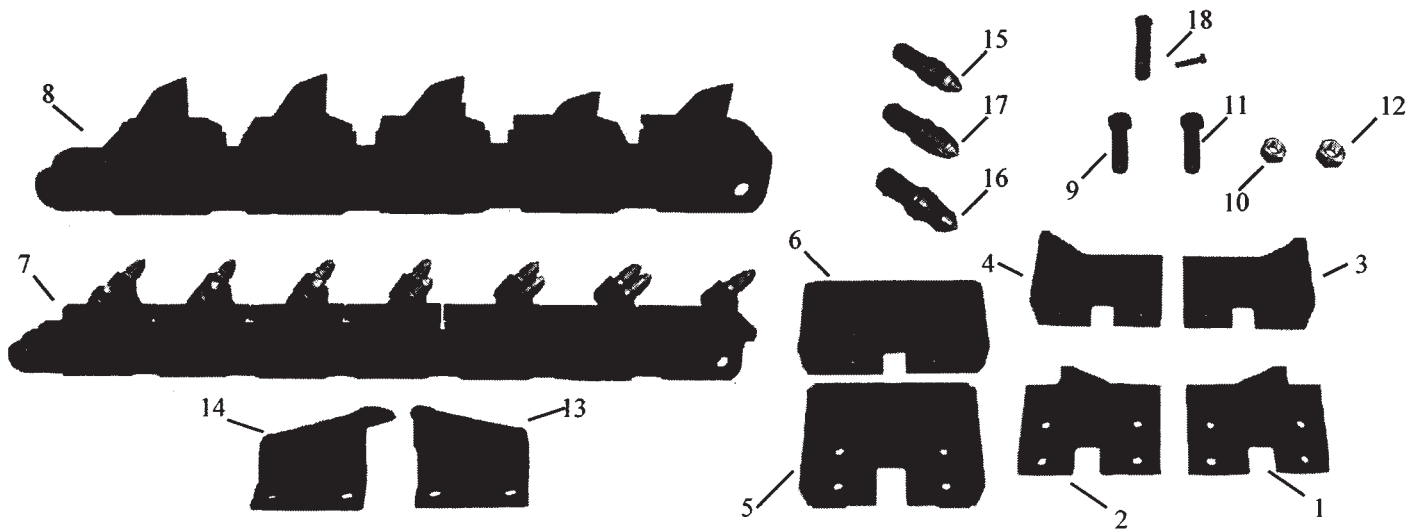

Ref. No.	Part No.	Description
1	V 15663001	Base Plate, 8", L.H. for 2134K Chain
2	V 15663002	Base Plate, 8", R.H. for 2134K Chain
3	V 15667001	Base Plate, 10" & 12", L.H. for 2134K Chain
4	V 15667002	Base Plate, 10" & 12", R.H. for 2134K Chain
5	V 15673001	Base Plate, 14", Double End for 2134K Chain
6	V 15678001	Base Plate, 16" & 18", Double End for 2134K Chain
7	AL 21340732	Alligator Style Chain, 7" Cut, Solid Welded Style Chain
7	AL 21340832	Alligator Style Chain, 8" Cut, Solid Welded Style Chain
7	AL 21340835	Alligator Style Chain, 8" Cut, Solid Welded Style Chain
8	SH 2134M0624	Terminator Style Chain, 24 T.AP, 6" Cut, Solid Welded Style Chain
8	SH 2134M0631	Terminator Style Chain, 31 T.AP, 6" Cut, Solid Welded Style Chain
8	SH 2134M0635	Terminator Style Chain, 35 T.AP, 6" Cut, Solid Welded Style Chain
9	V 384020	Base Plate Bolt - 5/8" X 18 X 2", Grade #8
10	V 396001	Base Plate Nut 5/8" X 18 Locknut
11	V 384016	Cup Cutter Mounting Bolt 5/8" X 1 3/4", Grade #8
12	V 396001	Cup Cutter Mounting Nut 5/8" X 18 Locknut
13	V 10642001	Cup Cutter, L.H.
14	V 10642002	Cup Cutter, R.H.
15	735 CB	.735 Full Cap Bit, Carbide
16	735 MB	.735, Rockbuster Bit, Carbide
17	735 HB	.735 Half Cap Bit, Carbide
18	V 13774001	Chain Pin Includes Keeper Pin

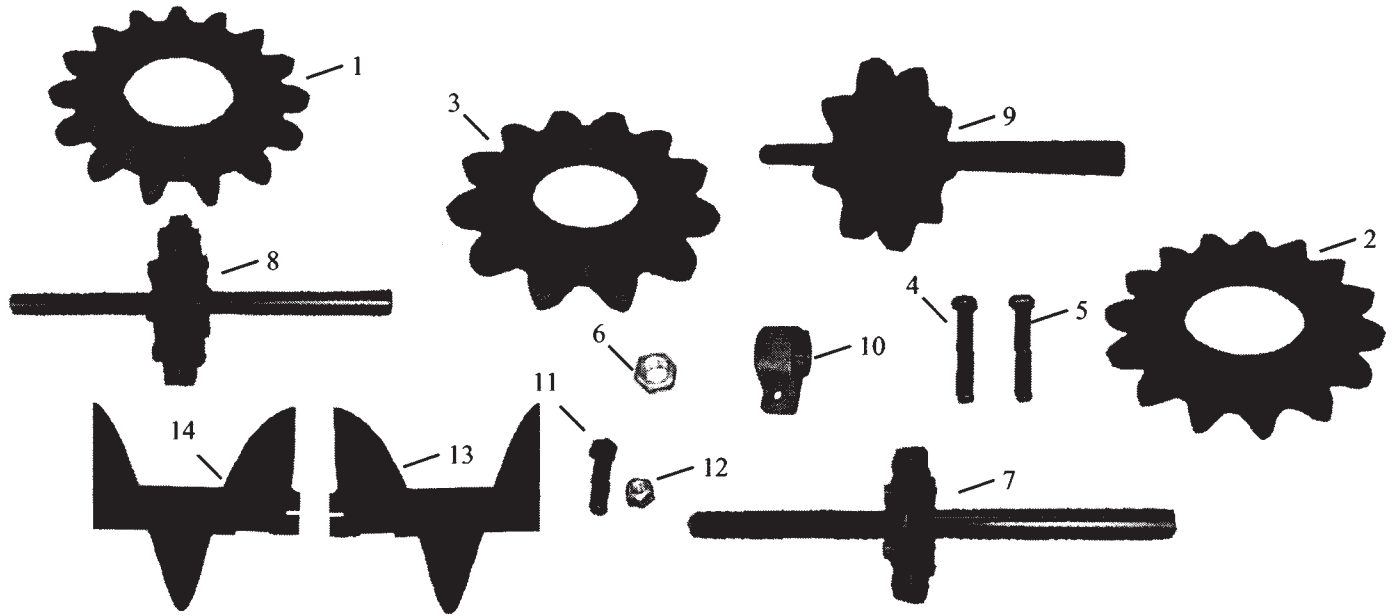

Ref. No.	Part No.	Description
1	V 206189001	Sprocket - 15T (3990)
2	V 254701001	Sprocket - 15T (2134)
3	V 201590001	Sprocket - 12T (7600)
4	V 70055034	Bolt - 7/8" - 9 X 3 1/2, Grade #8 Hex (To Fit Ref. #1 & 2)
5	V 72009001	Bolt - 7/8" X 9 X 4, Grade # 8 (To Fit Ref. #3)
6	V 83268001	7/8" - 9 Lock Nut Grade C (To Fit Ref. #1, 2 & 3)
7	V 206087001	Sprocket - 9T Auger Drive (3990)
8	V 248696001	Sprocket - 12T Auger Drive (2134)
9	V 248698001	Sprocket - 9T Auger Drive (7600)
10	V 65945001	Bearing Assembly
11	V 366030	5/8" - 11 X 3" Grade #5 Hex Bolt for Auger
12	V 430001	Locknut - 5/8" X 11, Grade C Zinc for Auger
13	V 200552003	12" Auger Assembly, L.H.
14	V 200552004	12" Auger Assembly, R.H.

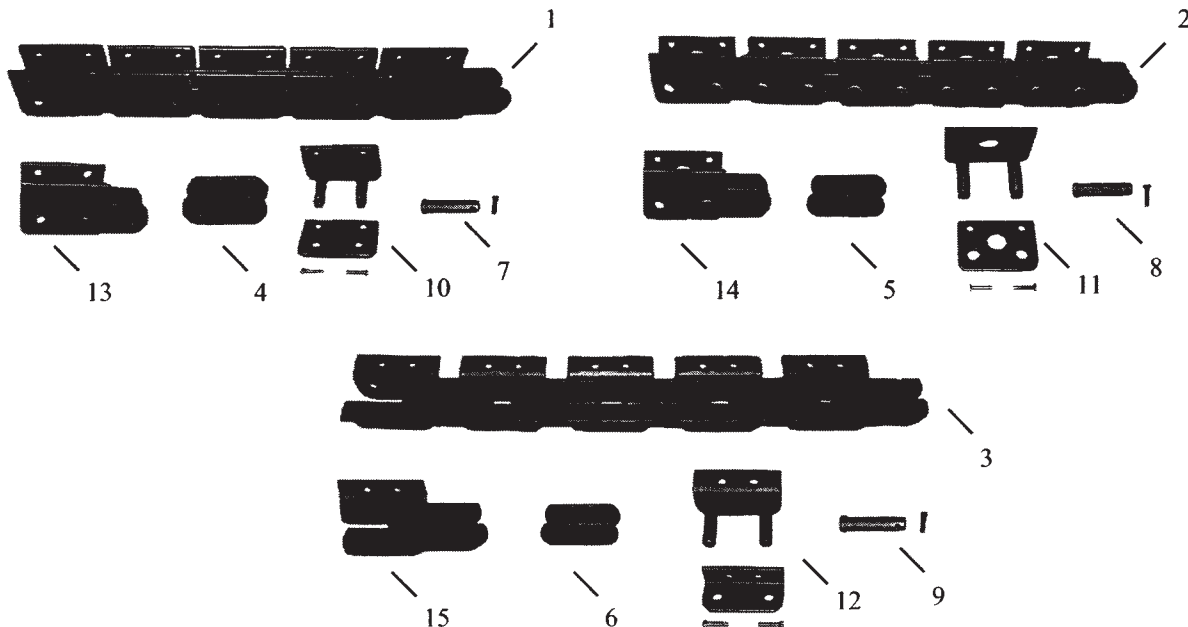

Ref. No.	Part No.	Description
1	B 2134M00B33	Bare Chain, 2134, 66 Pins, 48" Depth, 110,000 Lbs. Test, 3" Pitch
1	B 2134M00B37	Bare Chain, 2134, 74 Pins, 60" Depth, 110,000 Lbs. Test, 3" Pitch
1	B 2134M00B42	Bare Chain, 2134, 84 Pins, 72" Depth, 110,000 Lbs. Test, 3" Pitch
2	B 3990M00B33	Bare Chain, 3990, 66 Pins, 48" Depth, 90,000 Lbs. Test, 3" Pitch
2	B 3990M00B37	Bare Chain, 3990, 74 Pins, 60" Depth, 90,000 Lbs. Test, 3" Pitch
3	B 7600K00B25	Bare Chain, 7600K, 50 Pins, 48" Depth, 150,000 Lbs. Test, 4" Pitch
3	B 7600K00B28	Bare Chain, 7600K, 56 Pins, 60" Depth, 150,000 Lbs. Test, 4" Pitch
4	V 3088001	Roller Link 2134
5	B 3990MRL	Roller Link 3990
6	V 15648001	Roller Link 7600K
7	V 13774001	Chain Pin 2134 W / Keeper
8	B 3990MCP	Chain Pin 3990 W / Keeper
9	V 3091001	Chain Pin 7600K W / Keeper
10	B 2134MCL	Connecting Link 2134 W / Keeper
11	B 3990MCL	Connecting Link 3990 W / Keeper
12	V 15817001	Connecting Link 7600K W / Keeper
13	B 2134MRPL	Repair Link 2134 W / 2 Pins & Keepers
14	B 3990MRPL	Repair Link 3990 W / 2 Pins & Keepers
15	B 7600KRPL	Repair Link 7600K W / 2 Pins & Keepers
N/S	B 7600OF	Offset Link W / Pin
N/S	B 7600M00B25	Bare Chain, 7600M, 50 Pins, 48" Depth, 150,000 Lbs. Test, 4" Pitch
N/S	B 7600M00B28	Bare Chain, 7600M, 56 Pins, 60" Depth, 150,000 Lbs. Test, 4" Pitch



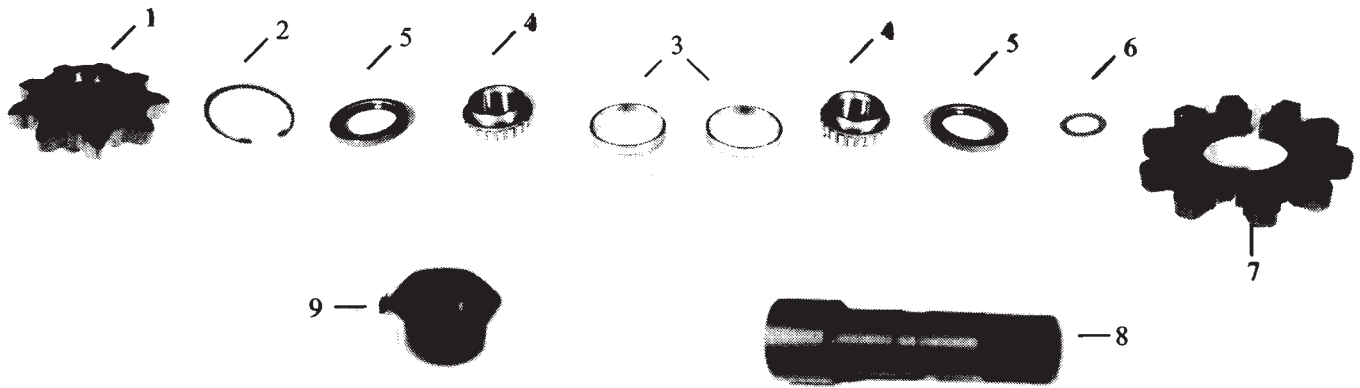

Ref. No.	Part No.	Description
1	V 7403001	9 Tooth Sprocket Assembly (Inc. Ref. #2 & #3)
N/S	V 7403001A	9 Tooth Sprocket W/Complete Assembly
N/S	V 7403001	9 Tooth Sprocket W/ Races and Snap Rings, 2 of ea. Req'd.
2	V 602362	Snap Ring, 2 Req'd.
3	V 1715001	Cup
4	V 1716001	Cone
5	V 3967001	Seal
6	V 483019	Washer - 2 1/2" O.D. X 2" I.D.
7	V 13618003	10 Tooth Split Sprocket (T600D Only)
8	V 7068003	Idler Pin
9	V 7137001	2" Nut
N/S	V 386034	Bolt - 3/4" X 16 X 3 1/2", Grade #8, 10 Req'd.
N/S	V 398001	Nut - 3/4" X 16 Locknut, 10 Req'd.
N/S	V 4488	9 Tooth Split Sprocket (T400C Only)

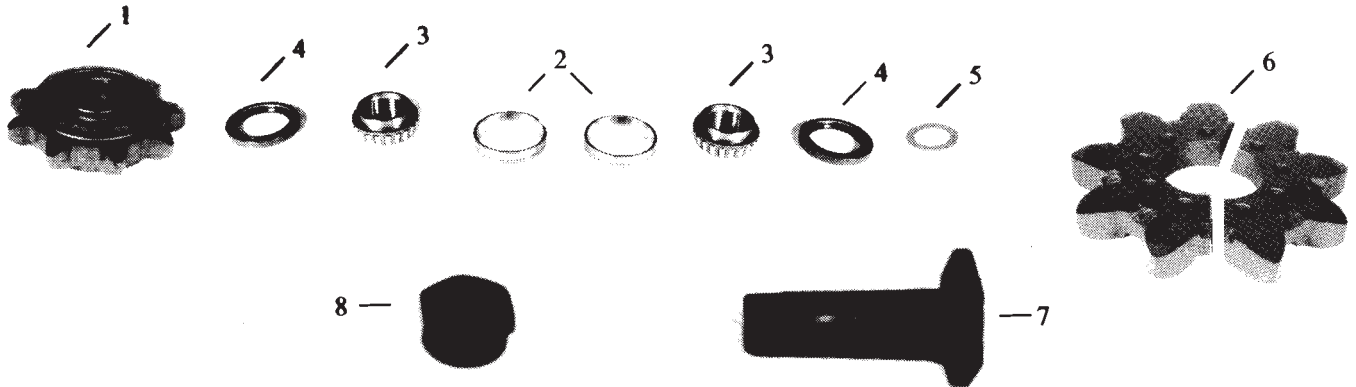

Ref. No.	Part No.	Description
1	V 2019	9T Idler Sprocket W/Rings and W/Cups (V 36759001)
N/S	V 2019A	9T Idler Sprocket W/Complete Assembly
N/S	V 2019	9T Idler Sprocket W/Races and Snap Rings, 2 of ea. Req'd.
2	V 1715021	Bearing Cut (Old #V 2024)
3	V 1716021	Bearing Cone (Old # V 2022)
4	V 3972001	Seal (Old # V 2023)
5	V 2513	Washer - 2 1/2" O.D. X 1 3/4" I.D. (As Req'd.)
6	V 4488	Split Sprocket (V 18923001)
7	V 14677003	Idler Shaft
8	V 14731001	Idler Nut - 1 3/4" Diameter
N/S	V 386034	Bolt - 3/4" X 16 X 3 1/2", Grade #8 for V4488 Sprocket, 9 Req'd.
N/S	V 398001	Locknut - 3/4" X 16

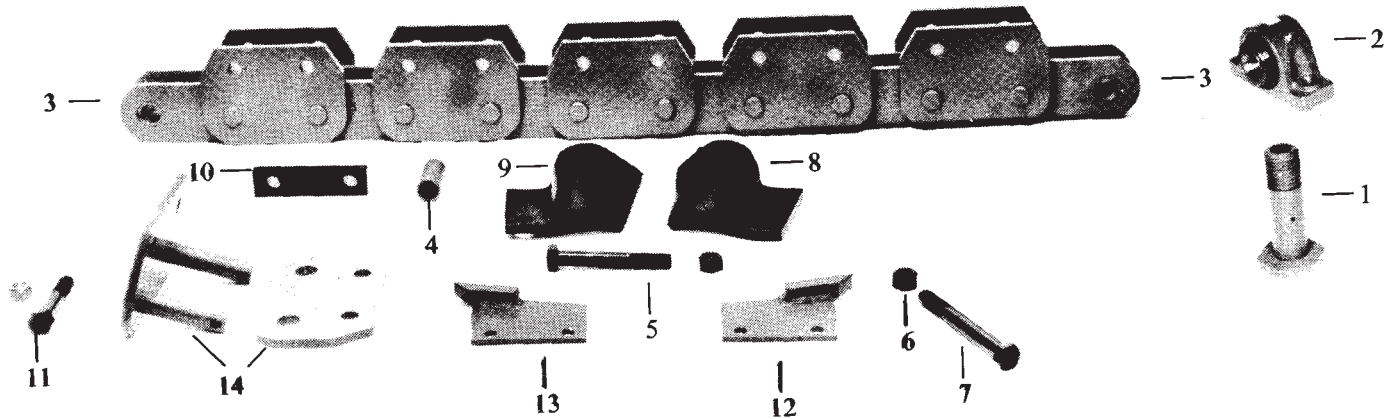

Ref. No.	Part No.	Description
1	V 4361	Grease Bolt - 1 3/4" X 5 3/8"
2	V 4276	1 3/4" Pillow Block Bearing
3	V 4859A	Chain 13' 4" Long
4	V 5054	Tube Spacer Tooth Mounted Outside - 1 1/8" OD X 11/16" ID X 2 3/8"
5	V 5116	Bolt - 5/8" X 18 X 4 1/2", Grade #8
6	V 7050	Locknut - 5/8" X 18, Grade C
7	V 5115	Bolt - 5/8" 18 X 5", Grade #8
8	V 10642002	Tooth, R.H. (Old #V 2108B)
9	V 10642001	Tooth, L.H. (Old #V 2109B)
10	V 5055	Spacer - 1/2" X 1 1/4" X 5"
11	V 6996	Bolt - 5/8" X 18 X 3 3/4", Grade #8
12	V 40501	Ground Breaker, L.H.
13	V 40502	Ground Breaker, R.H.
14	7600MCL	Connecting Link
N/S	7600OF	Offset Link
N/S	V 3091001	Connecting Pin

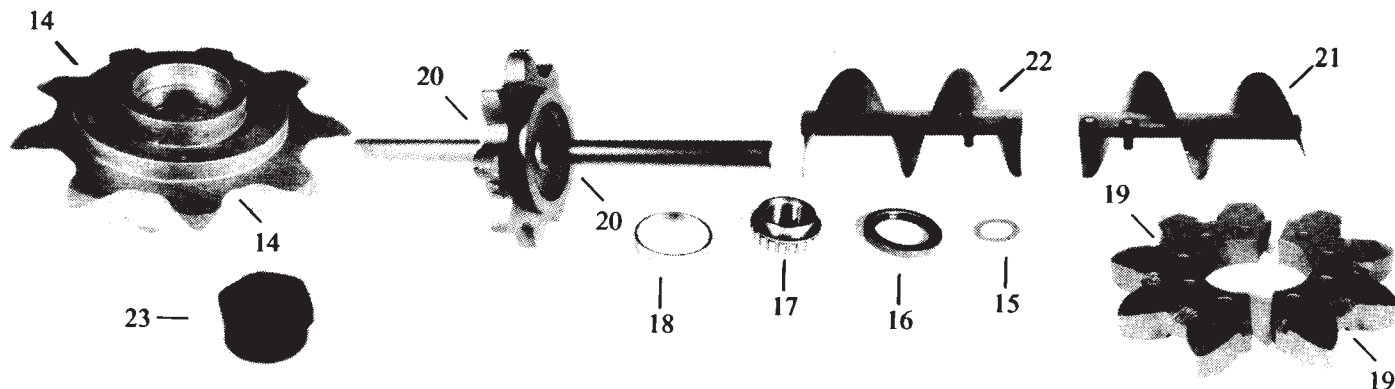

Ref. No.	Part No.	Description
14	V 4863	9T Idler Sprocket (V 39021001)
15	V 2512	Washer - 1 3/4" X 11 GA
16	V 2023	Seal (V 3972001)
17	V 2022	Bearing (V 1716021)
18	V 2024	Race (V 1715021)
19	V 4488	9T Drive Split Sprocket (V 18923001)
20	V 5123A	9T Auger Sprocket & Shaft (V27817003)
21	V 934	Auger, R.H., 24" Long
22	V 923	Auger, L.H., 24" Long
23	V 14731001	Nut - 1 3/4" for 4361 Grease Bolt
N/S	V 4858A	Chain 15' 4" Long
N/S	V 5009A	Chain 18' 4" Long
N/S	V 8597	Chain 20' 8" Long
N/S	V 386034	Bolt - 3/4" X 16 X 3 1/2", Grade #8, For 4488 Drive Sprocket, 9 Req'd.
N/S	V 9733	Spacer for 12" Cut
N/S	V 9734	Spacer for 14" Cut

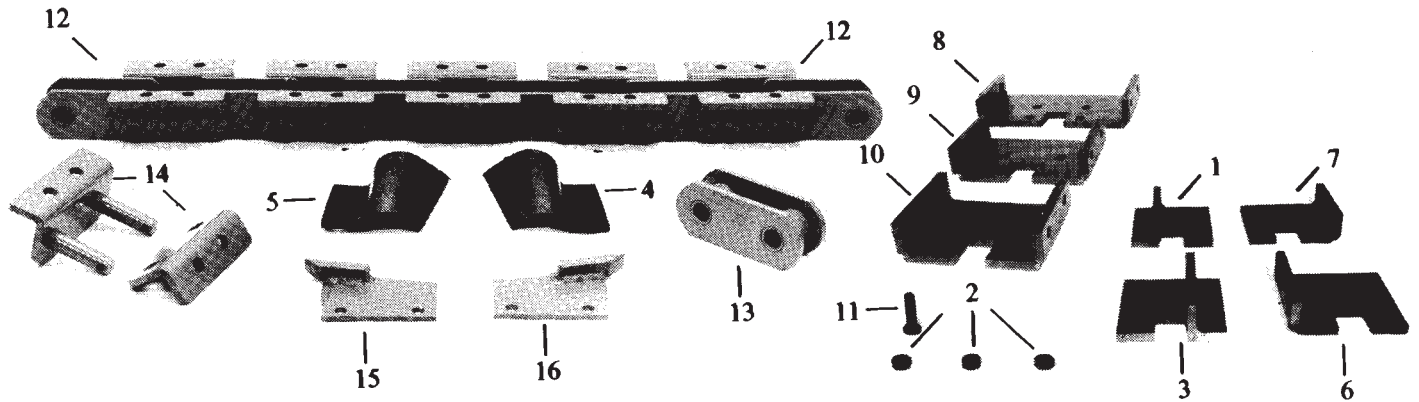

Ref. No.	Part No.	Description
1	V 2090	Cutter Base, 6", R.H. (V 36834002)
2	V 396001	5/8" X 18 Locknut (Old #T14877)
3	V 2091	Cutter Base, 6", R.H. (V 36834001)
4	V 10642002	Cutter, R.H. (Old #2108B)
5	V 10642001	Cutter, L.H. (Old #2109B)
6	V 2092	Cutter Base, 10", R.H. (V 36836002)
7	V 2093	Cutter Base, 10" L.H. (V 36836001)
8	V 16929	Cutter Base, 24", Double
9	V 16928	Cutter Base, 18", Double (V 47901001)
10	V 2094	Cutter Base, 14", Double (V 36837001)
11	V 384020	Bolt - 5/8" X 18 X 2" (Old #T2676), Plate to Chain
12	V 15645054	Chain 7600K 18' (T600D 3 Boom)
13	V 15648001	Roller Link
14	V 15817001	Connecting Link W / Keepers
15	V 40501	Ground Breaker, L.H.
16	V 40502	Ground Breaker, R.H.
N/S	V 3091001	Connecting Pin W / Cotter (Old #2032)
N/S	V 15645048	Chain 7600K, 16' (T400C 3 Boom)
N/S	V 15645057	Chain 7600K, 19' (T400C 4 Boom)
N/S	V 15645062	Chain 7600K, 20' 8" (T600D 4 Boom)
N/S	V 15645065	Chain 7600K, 21' 8" (T400C 5 Boom)
N/S	V 15645073	Chain 7600K, 24' 4" (T400C 6 Boom)
N/S	V 15645076	Chain 7600K, 25' 4" (T600D 6 Boom)
N/S	V 15645090	Chain 7600K, 30' (T600D 8 Boom)

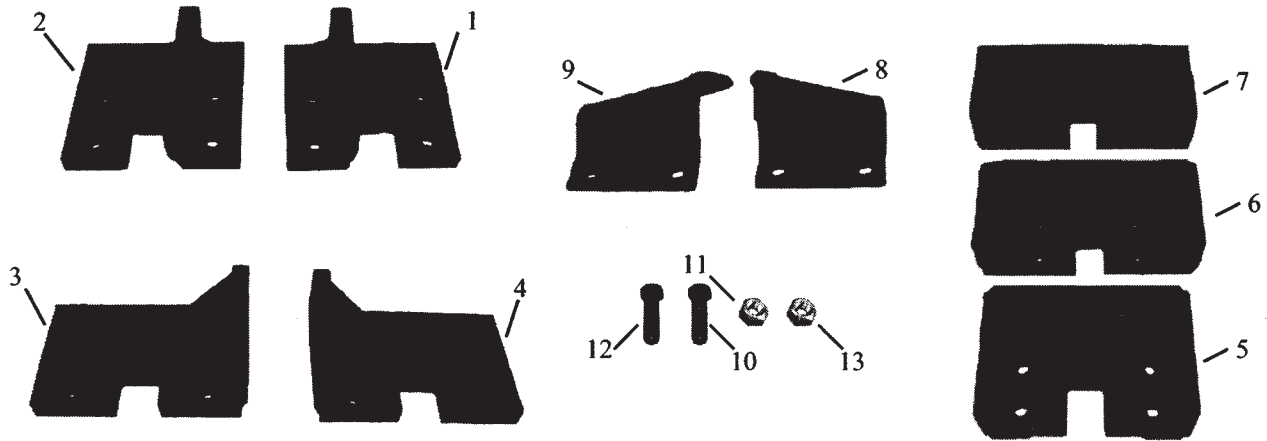

Ref. No.	Part No.	Description
1	V 2090	Base Plate, R.H.
2	V 2091	Base Plate, L.H.
3	V 2092	Base Plate, 10" & 12", R.H.
4	V 2093	Base Plate, 10" & 12", L.H.
5	V 2094	Base Plate, 14"-16", Double End
6	V 16928	Base Plate, 18"-20", Double End
7	V 16929	Base Plate, 22"-24", Double End
8	V 10642001	Cup Cutter, L.H.
9	V 10642002	Cup Cutter, R.H.
10	V 384020	Base Plate Bolt 5/8" X 18 X 2", Grade #8
11	V 396001	5/8" X 18 Locknut
12	V 384016	Cup Cutter Mounting Bolt - 5/8" X 2"
13	V 396001	Cup Cutter Mounting Locknut - 5/8" X 18

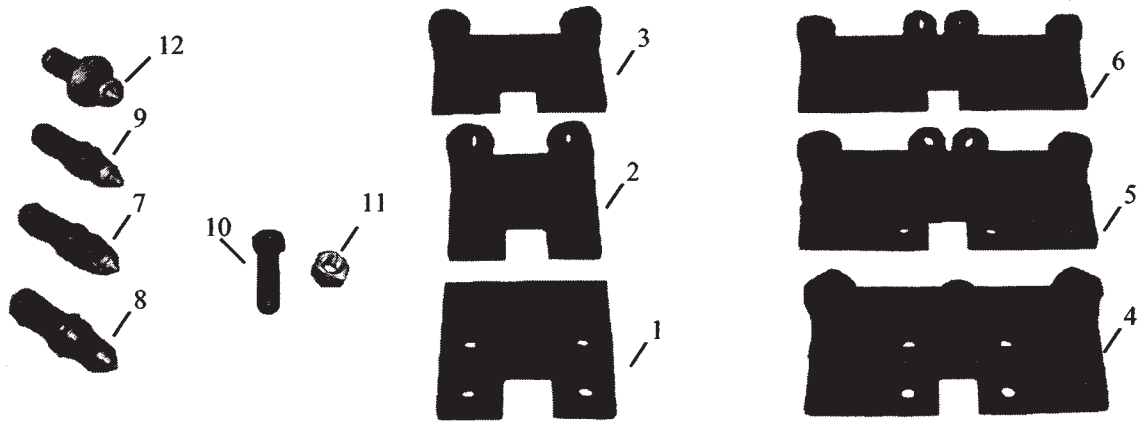

Ref. No.	Part No.	Description
1	V 13636001	Rock & Frost Base Plate, Center Cut
N/S	V 13638001	Rock & Frost Base Plate, 3"
2	V 13639001	Rock & Frost Base Plate, 4"
N/S	V 13640001	Rock & Frost Base Plate, 5"
3	V 13641001	Rock & Frost Base Plate, 6"
N/S	V 13643001	Rock & Frost Base Plate, 7"
N/S	V 13644001	Rock & Frost Base Plate, 8"
N/S	V 13645001	Rock & Frost Base Plate, 9"
N/S	V 13647001	Rock & Frost Base Plate, 10"
N/S	V 13649001	Rock & Frost Base Plate, 11"
N/S	V 13651001	Rock & Frost Base Plate, 12"
N/S	V 13648001	Base Plate, 9"-10" (9" & 10") W / 4 Pockets
N/S	V 13652001	Base Plate, 11"-12" (11" & 12") W / 4 Pockets
4	V 13653001	Base Plate, 13"-14" (C - 13" & 14") W / 5 Pockets
5	V 13655001	Base Plate, 15"-16" (3" - 15" & 16") W / 6 Pockets
N/S	V 13657001	Base Plate, 17"-18" (4" - 17" & 18") W / 6 Pockets
6	V 13659001	Base Plate, 19"-20" (6" - 19" & 20") W / 6 Pockets
7	735 HB	.735 Rockbuster Bit
8	735 MB	.735 Half Cap Bit
9	735 CB	.735 Full Cap Bit
10	V 384020	5/8" X 18 X 2 Gr. 8 Bolt
11	V 396001	5/8" X 18 Gr. C Top Lock Nut
12	735 CRFN	.735 Bit W / Clip, Umbrella Style

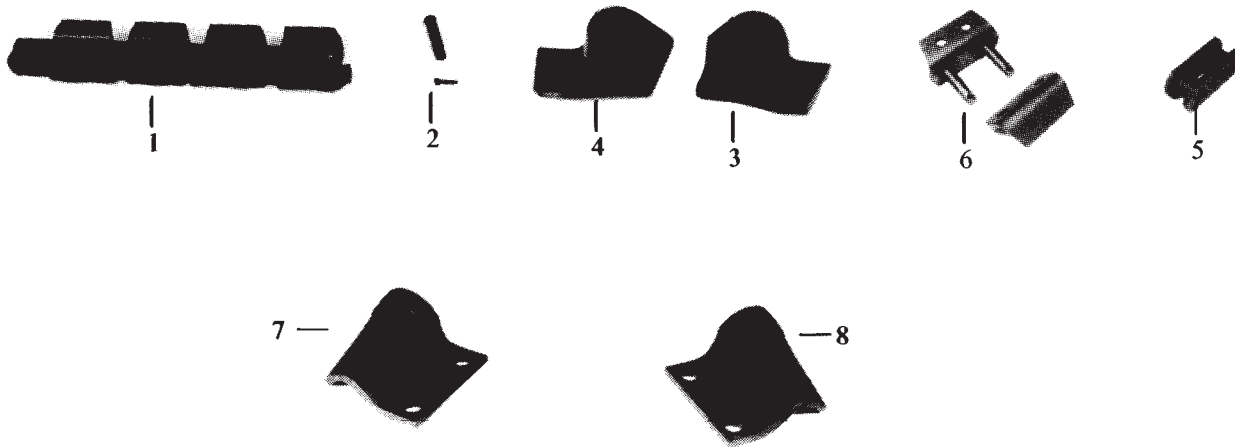

Ref. No.	Part No.	Description
1	V 3098064	Chain 21' 4" Long, 64 Pitch, 4' Depth W / 20" Idler
2	V 3091003	Chain Pin W / Keeper
3	V 64732002	Cutter Tooth 7" Cup, R.H. (For 650s), 3/4" Hole
4	V 64732001	Cutter Tooth 7" Cup, L.H. (For 650s), 3/4" Hole
5	V 3088009	Link - No. 2109K Roller
6	V 3089005	Link - No. 2109K Connector W / Keepers
7	V 10642002	Cutter, R.H., 5/8" Hole
8	V 10642001	Cutter, L.H., 5/8" Hole
N/S	V 3094094	Chain 31' 4" Long, 94 Pitch, 8' Depth W / 40" Idler
N/S	V 3098076	Chain 25' 4" Long, 76 Pitch, 4' Depth W / 40" Idler
N/S	V 3098078	Chain 26' Long, 78 Pitch, 6' Depth W / 20" Idler
N/S	V 3098082	Chain 27' 4" Long, 82 Pitch, 6' Depth W / 40" Idler
N/S	V 3098094	Chain 31' 4" Long, 94 Pitch, 8' Depth W / 20" Idler
N/S	V 3098108	Chain 36' Long, 108 Pitch, 10' Depth W / 20" Idler
N/S	V 3098122	Chain 40' 8" Long, 122 Pitch, 21' Depth W / 20" Idler



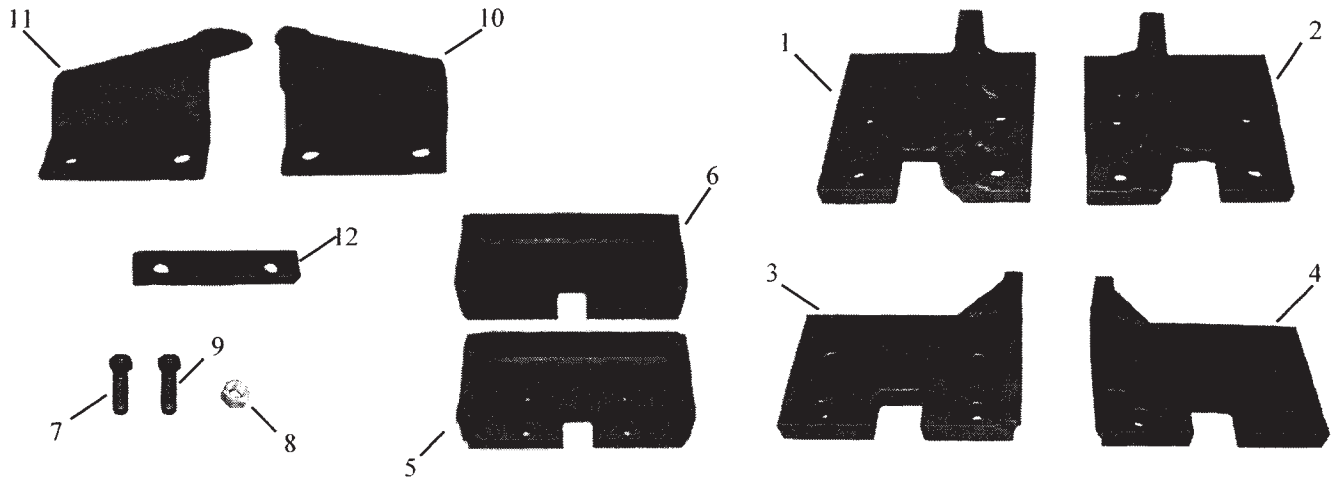

Ref. No.	Part No.	Description
1	V 82132001	Base Plate, 8", L.H.
2	V 82136001	Base Plate, 8", R.H.
3	V 82139001	Base Plate, 12", R.H. (& 14")
4	V 82137001	Base Plate, 12", L.H. (& 14")
5	V 82140001	Base Plate, 18", Double End
6	V 82144001	Base Plate, 20" - 22", Double End
7	V 386024	3/4" X 16 X 2 1/2" Base Plate Bolt, Grade #8
8	V 398001	3/4" X 16 Locknut
9	V 386020	3/4" X 16 X 2" Cup Cutter Mounting Bolt, Grade #8
10	V 64732001	Cup Cutter, L.H., 3/4" Hole
11	V 64732002	Cup Cutter, R.H., 3/4" Hole
12	V 82142001	Spacer Block for 10" & 16" Cut (Requires V 386026 - 3/4" X 16 X 3" Bolt, Grade #8)

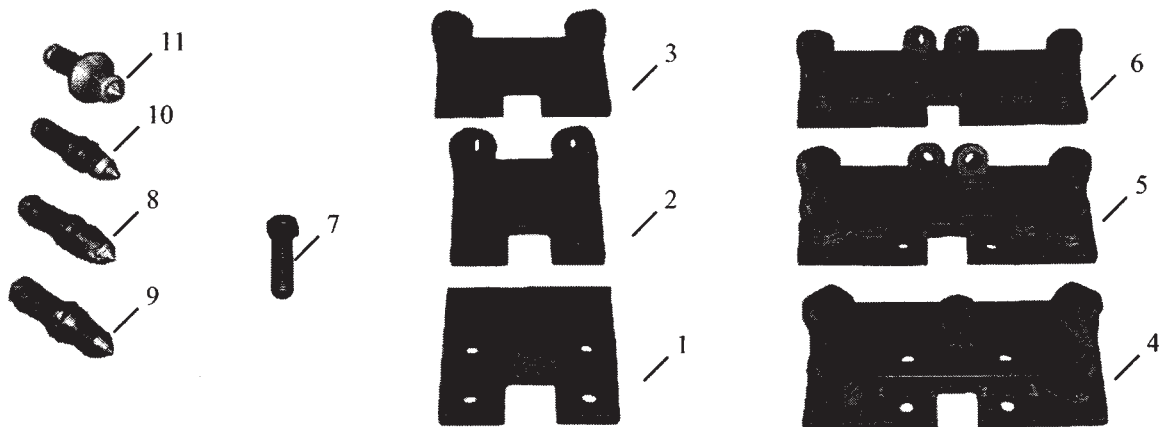

Ref. No.	Part No.	Description
1	V 13565001	Rock & Frost Base Plate, Center Cut, 1" Thick
N/S	V 13567001	Rock & Frost Base Plate, 3", 1" Thick
2	V 13568001	Rock & Frost Base Plate, 4", 1" Thick
N/S	V 13569001	Rock & Frost Base Plate, 5", 1" Thick
3	V 13570001	Rock & Frost Base Plate, 6", 1" Thick
N/S	V 13571001	Rock & Frost Base Plate, 7", 1" Thick
N/S	V 13572001	Rock & Frost Base Plate, 8", 1" Thick
N/S	V 13574001	Rock & Frost Base Plate, 10", 1" Thick
N/S	V 13576001	Rock & Frost Base Plate, 12", 1" Thick
4	V 13578001	Base Plate, 13" - 14" (C - 13" & 14") W / 5 Pockets
N/S	V 13580001	Base Plate, 15" - 16" (3" - 15" & 16") W / 6 Pockets
5	V 13582001	Base Plate, 17" - 18" (4" - 17" & 18") W / 6 Pockets
N/S	V 13584001	Base Plate, 19" - 20" (5" - 19" & 20") W / 6 Pockets
6	V 13586001	Base Plate, 22" - 24" (6" - 22" & 24") W / 6 Pockets
7	V 386024	3/4" X 16 X 2 1/2" Base Plate Mounting Bolt, Grade #8
N/S	V 398001	3/4" X 16 Locknut
8	735 HB	.735 Rockbuster Bit
9	735 MB	.735 Half Cap Bit
10	735 CB	.735 Full Cap Bit
11	735 CRFN	.735 Bit W / Clip, Umbrella Style

\* Note: Plates available in T-1 Steel, call for a quote.

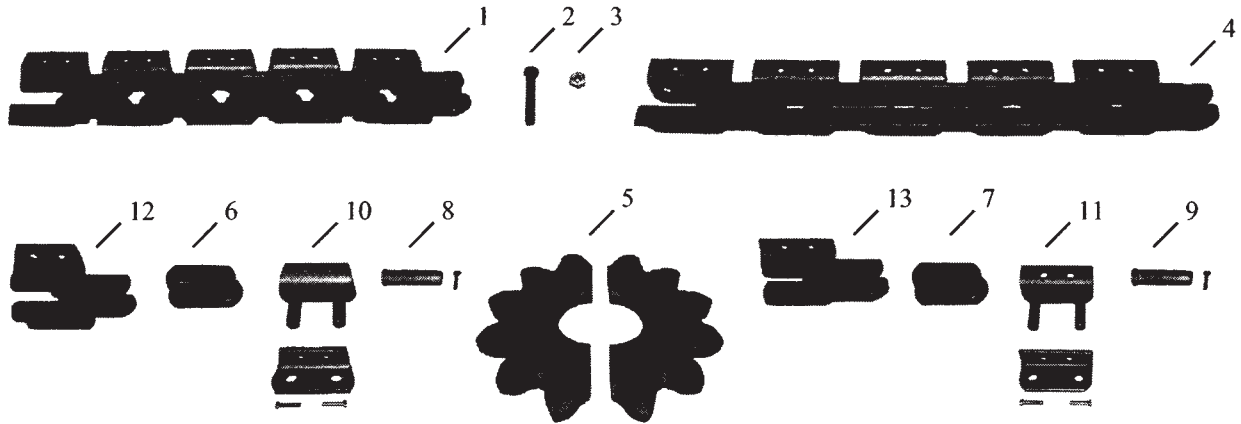

Ref. No.	Part No.	Description
1	B 2109K00B32	2109K - 64 Pitch, 4 Boom, Qty. 1 Req'd., 190,000 Lbs. Test
1	B 2109K00B35	2109K - 70 Pitch, 5 Boom, Qty. 1 Req'd., 190,000 Lbs. Test
1	B 2109K00B38	2109K - 76 Pitch, 6 Boom, Qty. 1 Req'd., 190,000 Lbs. Test
2	V 386030	Bolt - 3/4" - 16 X 3" Grade #8 Hex, Qty. 10 Req'd. (Sprocket to Hub)
3	V 398001	Locknut - 3/4" X 16 Grade C, Qty. 10 Req'd. (Sprocket to Hub)
4	B 7600K00B32	7600K - 64 Pitch, 4 Boom, Qty. 1 Req'd., 150,000 Lbs. Test
4	B 7600K00B35	7600K - 70 Pitch, 6 Boom, Qty. 1 Req'd., 150,000 Lbs. Test
4	B 7600K00B38	7600K - 76 Pitch, 6 Boom, Qty. 1 Req'd., 150,000 Lbs. Test
5	V 904230001	Sprocket 12T 7600 / 2109 Chain, Qty. 1 Req'd., 150,000 Lbs. Test
6	V 3088009	2109K Roller Link W / Keepers
7	V 15648001	7600K Roller Link W / Keepers
8	V 3091003	2109K Chain Pin W / Keepers
9	V 3091001	7600K Chain Pin W / Keepers
10	V 3089005	2109K Connecting Link W / 2 Pins & Keepers
11	V 15817001	7600K Connecting Link W / 2 Pins & Keepers
12	B 2109KRPL	2109K Repair Link W / 2 Pins & Keepers
13	B 7600KRPL	7600K Repair Link W / 2 Pins & Keepers
N/S	7600 OF	7600K Offset Link W / 2 Pins & Keepers

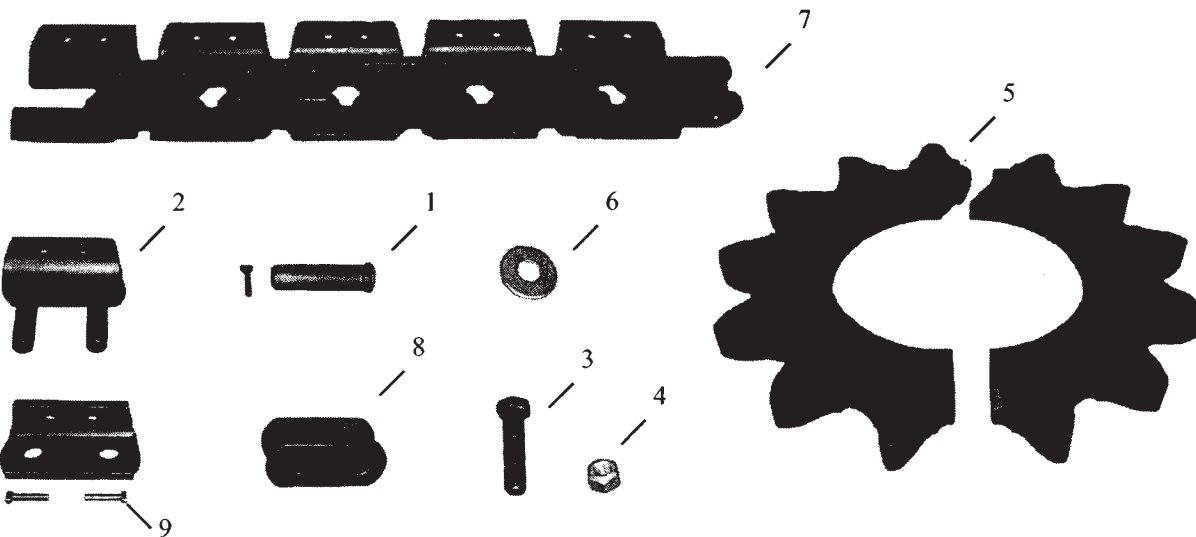

Ref. No.	Part No.	Description
1	V 59925001	4501K Chain Pin W / Cotter
2	V 59924001	4501K Connecting Link W / Cotter
3	V 386034	3/4" - 16 X 3 1/2" Grade #8 Hex Bolt (Qty. 12)
4	V 398001	Nut - 3/4" X 16 Grade C Locknut (Qty. 12)
5	V 78377001	Sprocket - 13 Tooth (Qty. 1)
6	V 85979001	Washer - 3/4" Harden (Qty. 24)
7	B 4501K00B74	4501K Chain - 74 Pitch, 6' Depth
8	V 59923001	Roller Link
9	TH-4	T Head Keeper

\*Note: See page 48 for HD 4525 to replace 4501K Chain.

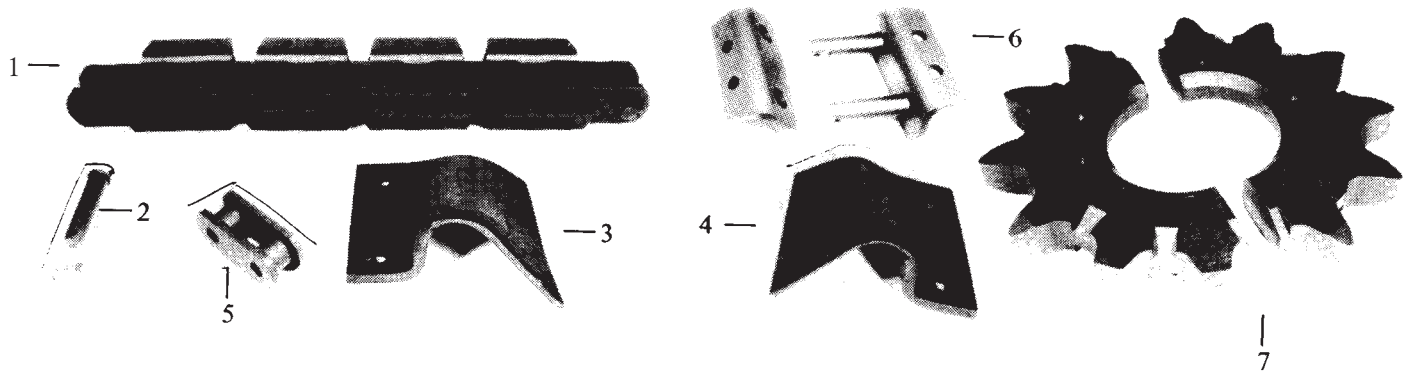

Ref. No.	Part No.	Description
1	V 59926058	Chain 21' 9" Long, 58 Pitch, 4' Depth W / 20" & 40" Idler
2	V 59925001	Chain Pin W / Cotter
3	V 10643002	Cutter, R.H., 3/4" Hole
4	V 10643001	Cutter, L.H., 3/4" Hole
5	V 59923001	Link - No. 4501K Roller
6	V 59924001	Link - No. 4501K Connector W / Cotters
7	V 59376001	Drive Sprocket (For T800C & T800B)
N/S	V 59426072	Chain 27' Long, 72 Pitch, 6' Depth W / 40" Idler
N/S	V 59926068	Chain 25' 6" Long, 68 Pitch, 6' Depth W / 20" Idler
N/S	V 59926084	Chain 31' 6" Long, 84 Pitch, 8' Depth W / 20" Idler
N/S	V 59926096	Chain 36' Long, 96 Pitch, 10' Depth W / 20" Idler
N/S	V 59926108	Chain 40' 6" Long, 108 Pitch, 12' Depth W / 20" Idler
N/S	V 78377001	Drive Sprocket for T650
N/S	TH-9	T Head Keeper

\* Note: See page 48 for HD 4525 to replace 4501K Chain.

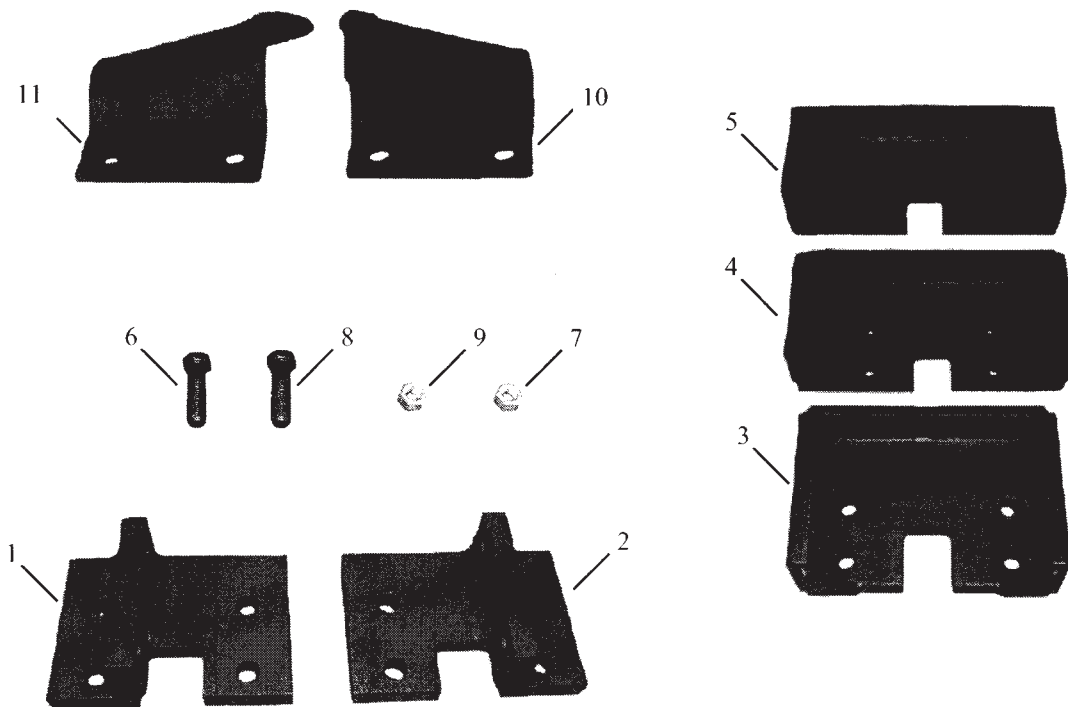

Ref. No.	Part No.	Description
1	V 46855001	Base Plate. R.H.
2	V 46856001	Base Plate. L.H.
3	V 46858001	Base Plate. 14" - 16", Double End
4	V 46859001	Base Plate. 18" - 20", Double End
5	V 46860001	Base Plate. 22" - 24", Double End
6	V 386024	3/4" X 16 X 2 1/2" Base Plate Mounting Bolt, Grade #8
7	V 398001	3/4" X 16 Base Plate Mounting Locknut
8	V 386022	3/4" X 16 X 2 1/4" Bolt for Tooth to Base, Grade #8
9	V 398001	3/4" X 16 Locknut
10	V 10643001	Cup Cutter, L.H.
11	V 10643002	Cup Cutter, R.H.

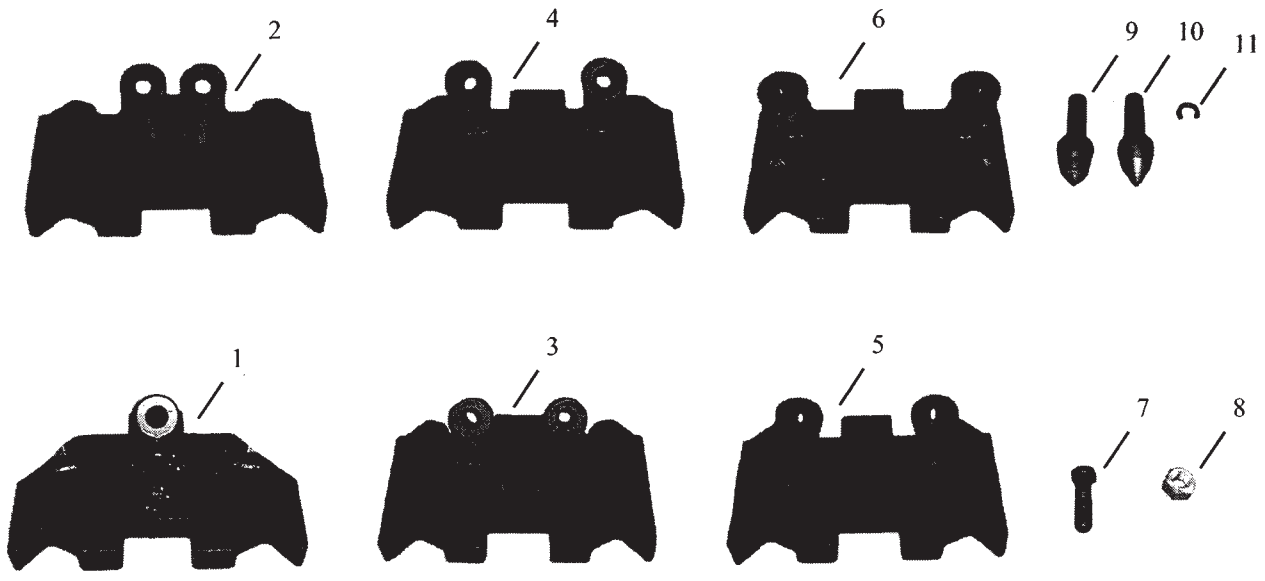

Ref. No.	Part No.	Description
1	V 304333001	Rock & Frost Base Plate, Center Cut
2	V 304334001	Rock & Frost Base Plate, 4"
3	V 304335001	Rock & Frost Base Plate, 6"
4	V 304336001	Rock & Frost Base Plate, 8"
5	V 304337001	Rock & Frost Base Plate, 9"
6	V 304338001	Rock & Frost Base Plate, 10 1/2"
7	V 386034	3/4" X 16 X 3 1/2", Grade #8 Bolt
8	V 398001	3/4" X 16 Gr. C Top Lock Nut
9	990 SRF	Rock & Frost Bit, HD Carbide, Hard Rock Conditions
10	990 CRF	Rock & Frost Bit, Carbide, Abrasive Conditions
11	K 01	Clip

\* Note: Plates available in T-1 steel, call for a quote.

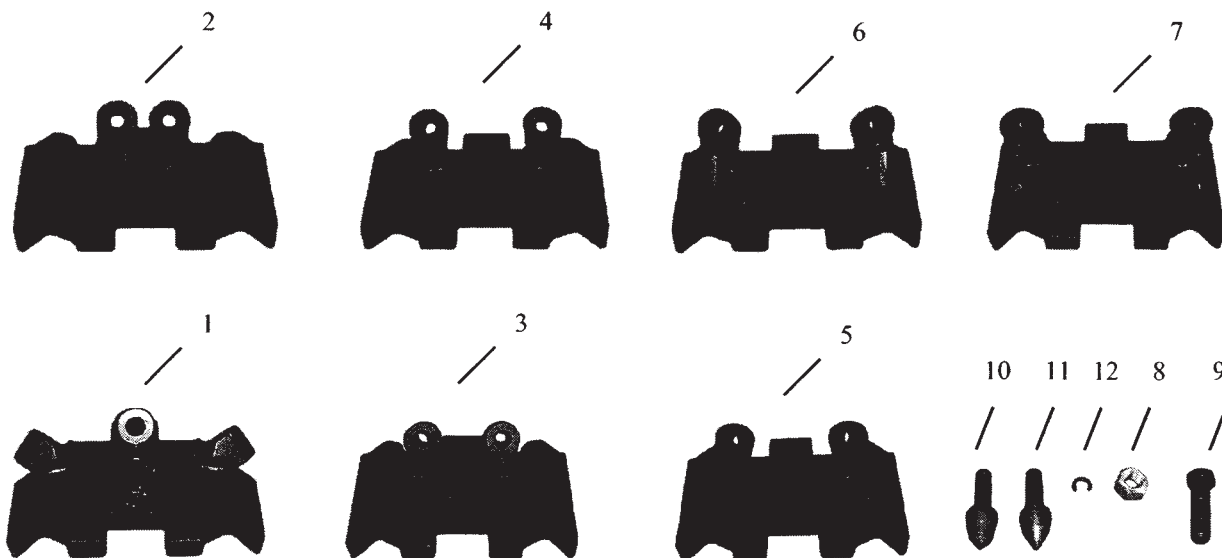

Ref. No.	Part No.	Description
1	V 68032001	Rock & Frost Base Plate, Center Cut
2	V 68034001	Rock & Frost Base Plate, 4"
3	V 68036001	Rock & Frost Base Plate, 6"
4	V 68037001	Rock & Frost Base Plate, 8"
5	V 68038001	Rock & Frost Base Plate, 10"
6	V 68039001	Rock & Frost Base Plate, 12"
7	V 68040001	Rock & Frost Base Plate, 14"
8	V 386034	3/4" X 16 X 3 1/2", Grade #8 Bolt
9	V 398001	3/4" X 16 Gr. C Top Lock nut
10	990 SRF	Rock & Frost Bit, HD Carbide, Hard Rock Conditions
11	990 CRF	Rock & Frost Bit, Carbide, Abrasive Conditions
12	K 01	Clip

\* Note: Plates available in T-1 steel, call for a quote.



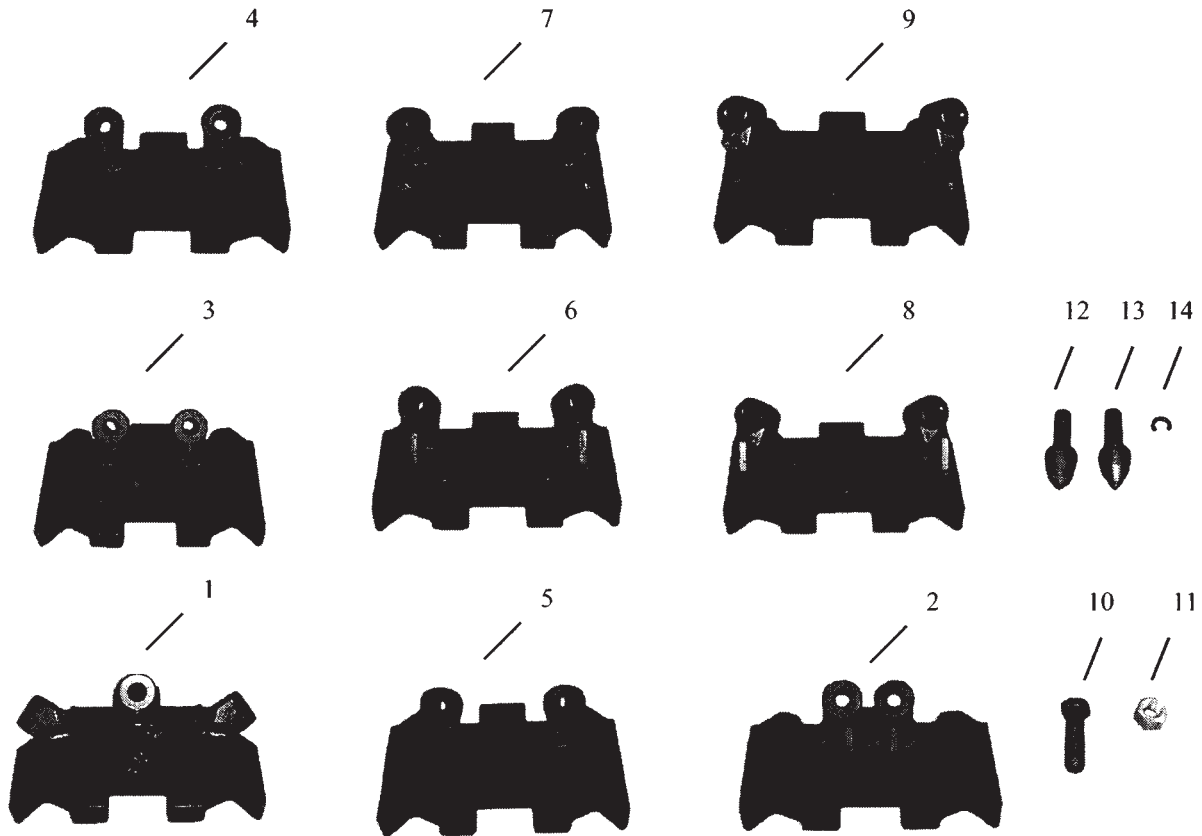

Ref. No.	Part No.	Description
1	V 68047001	Rock & Frost Base Plate, Center Cut
2	V 68049001	Rock & Frost Base Plate, 4"
3	V 68051001	Rock & Frost Base Plate, 6"
4	V 68052001	Rock & Frost Base Plate, 8"
5	V 68053001	Rock & Frost Base Plate, 10"
6	V 68054001	Rock & Frost Base Plate, 12"
7	V 68055001	Rock & Frost Base Plate, 14"
8	V 68056001	Rock & Frost Base Plate, 16"
9	V 68057001	Rock & Frost Base Plate, 18"
10	V 386034	3/4" X 16 X 3 1/2", Grade #8 Bolt
11	V 398001	3/4" X 16 Gr. C Top Lock Nut
12	990 SRF	Rock & Frost Bit, HD Carbide, Hard Rock Conditions
13	990 CRF	Rock & Frost Bit, Carbide, Abrasive Conditions
14	K 01	Clip

\* Note: Plates available in T-1 steel, call for a quote.

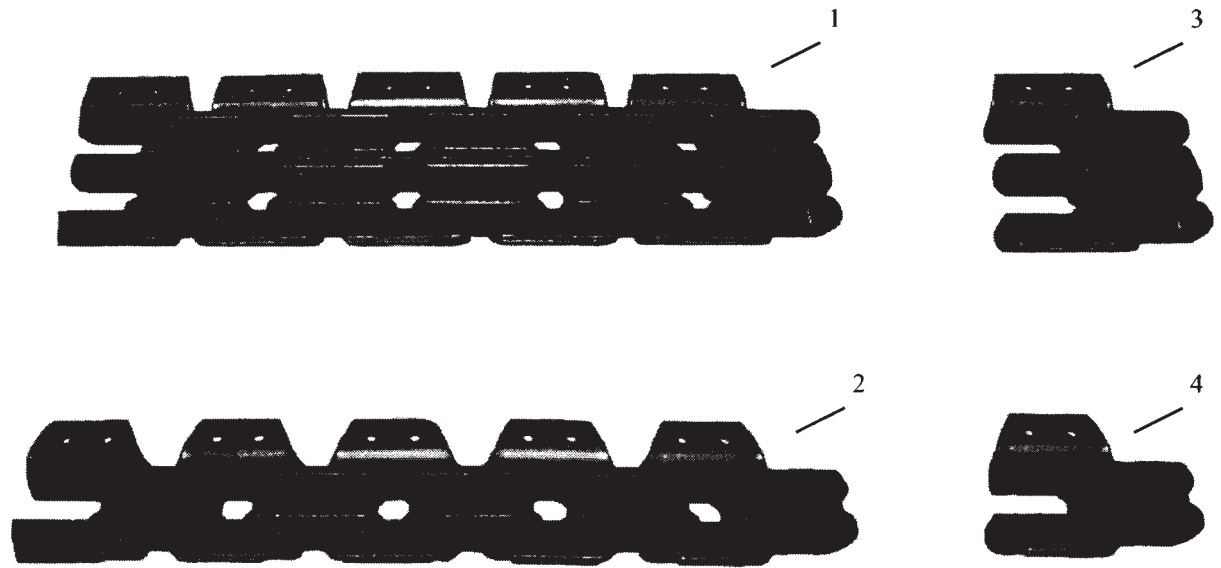

Ref. No.	Part No.	Description
1	B 4502K00B42	Double 4501K Chain, 84 Pitch
1	B 4502K00B37	Double 4501K Chain, 74 Pitch
2	TA 4525K00B42	Extra Heavy-Duty 4501 Chain, 84 Pitch
2	TA 4525K00B37	Extra Heavy-Duty 4501 Chain, 74 Pitch
3	B 4502K00B01	4502 Repair Link, Includes 2 Pins & Keepers
4	B 4525K00B01	4525 Repair Link, Includes 2 Pins & Keepers
N/S	B 4502KCL	Connecting Link (4502 Chain) W / Keeper
N/S	B 4502KRL	Roller Link (4502 Chain)
N/S	4525KCL	Connecting Link (4525 Chain) W / Keeper
N/S	4525KRL	Roller Link (4525 Chain)
N/S	TH-4	T Head Keeper



### To Order Roller Chain

1. Measure Length of Pitch
2. Count the number of pitches or rollers
3. From one pin to the next pin equals one pitch

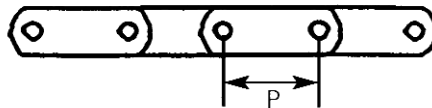

P = One Pitch

Part No.	Description
40R	#40 Roller Chain, Pitch Length 1/2"
40CL	#40 Conn. Link
400L	#40 Offset Link
50R	#50 Roller Chain, Pitch Length 5/8"
50CL	#50 Conn. Link
500L	#50 Offset Link
60R	#60 Roller Chain, Pitch Length 3/4"
60CL	#60 Conn. Link
600L	#60 Offset Link
60HR	#60 Heavy Roller Chain, Pitch Length 3/4"
60HCL	#60 Heavy Conn. Link
60HOL	#60 Heavy Offset Link
60-2R	#60 Double Roller Chain, Pitch Length 3/4"
60-2CL	#60 Double Conn. Link
60-2OL	#60 Double Offset Link
80HR	#80 Heavy Roller Chain, Pitch Length 1"
80HCL	#80 Heavy Conn. Link
80HOL	#80 Heavy Offset Link
100HR	#100 Heavy Roller Chain, Pitch Length 1 1/4"
100HCL	#100 Heavy Conn. Link
100HOL	#100 Heavy Offset Link
120R	#120 Roller Chain, Pitch Length 1 1/2"
120CL	#120 Conn. Link
160R	#160 Roller Chain, Pitch Length 2"
160CL	#160 Conn. Link

**We stock nearly every size of Roller Chain.**





# Warning

## **Use Care To Prevent Injury Comply with the Following to Avoid Serious Personal Injury**

1. Guards must be provided on all chain and sprocket installations in accordance with provisions of ANSI/ASME B15.1 - 1996 "Safety Standards for Mechanical Power Transmission Apparatus," and ANSI/ASME B20.1 - 1996 "Safety Standards for Conveyors and Related Equipment," or other applicable safety standards. When revisions of these standards are published, the updated edition shall apply.
2. Always lock out power switch before installing, removing, lubricating or servicing a chain system.
3. When connecting or disconnecting chain:
  - a. Eye protection is required. Wear safety glasses, protective clothing, gloves, and safety shoes.
  - b. Support the chain to prevent uncontrolled movement of chain and parts.
  - c. Use of pressing equipment is recommended. Tools must be in good condition and properly used.
  - d. Determine correct direction for pin/rivet removal or insertion.